



SHREEJI  
GROUP  
Building Bonds of Trust



SHREEJI  
ASPIRE

Orlem, Malad (West)

## AMENITIES



Gymnasium



Club House



Indoor Games



Children Play Area



Senior Citizen Sitting Area



Enclosed Parking

## CONNECTIVITY



Western Express Highway



Malad Railway Station



Link Road



Schools & Colleges



Healthcare



Market



Restaurants



Malls



Recreational Parks

### CONNECTIVITY

- Western Express Highway - 20 Mins • Proposed Metro Railway Station
- Malad Railway Station - 18 Mins • Link Road - 03 Mins

### SCHOOLS & COLLEGES:

- St Anne's High School - 03 Mins • Shri Balaji International School - 06 Mins
- St Joseph's School - 05 Mins • N.L. College - 20 Mins • Saraf College - 20 Mins

### HEALTHCARE:

- Oscar Multi Speciality Hospital - 04 Mins • Lifeline Multi Speciality Hospital - 03 Mins
- Tunga Hospital - 05 Mins

### MARKET - 04 Mins

### MALLS: • Inorbit Mall - 15 Min • Infinity Mall - 15 Min • Hypercity Mall - 15 Min

### RECREATIONAL PARKS: • Essel World - 30 Min • Water Kingdom - 30 Min



SHREEJI  
ASPIRE

Located at Orlem, Malad (West), Shreeji Aspire is for those who believe in quality living. A premium residential tower with affordable yet extremely comfortable 1 & 2 BHK homes. Shreeji Aspire stands as a new symbol of class with all necessary amenities & comfort.



# Typical Floor Plans

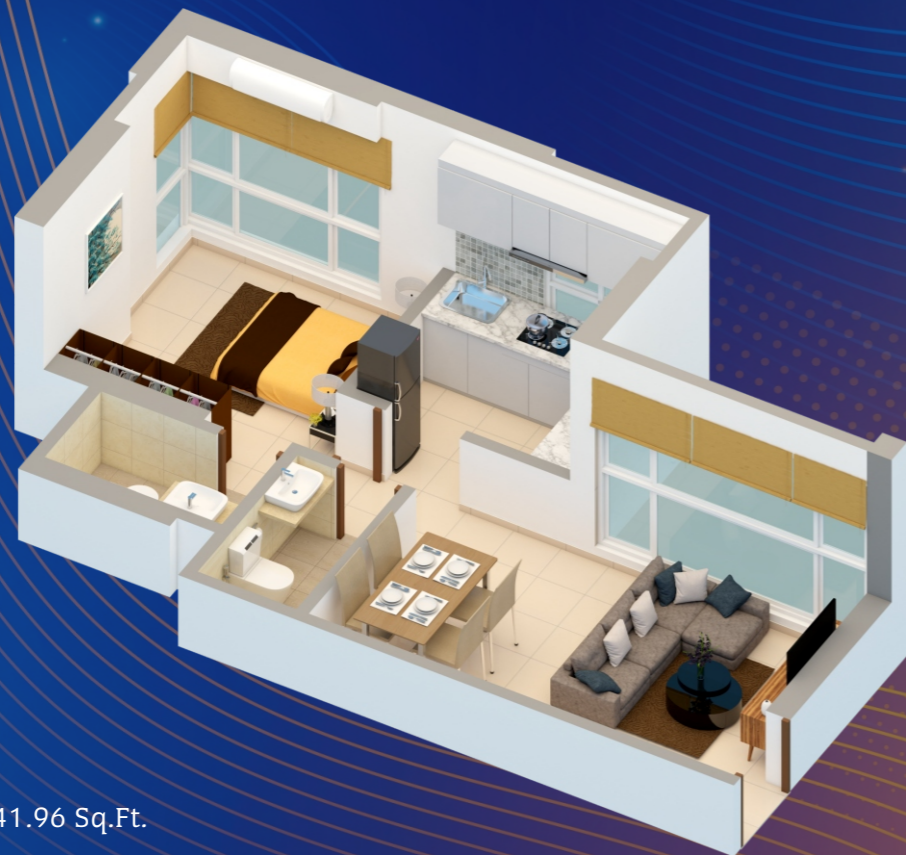
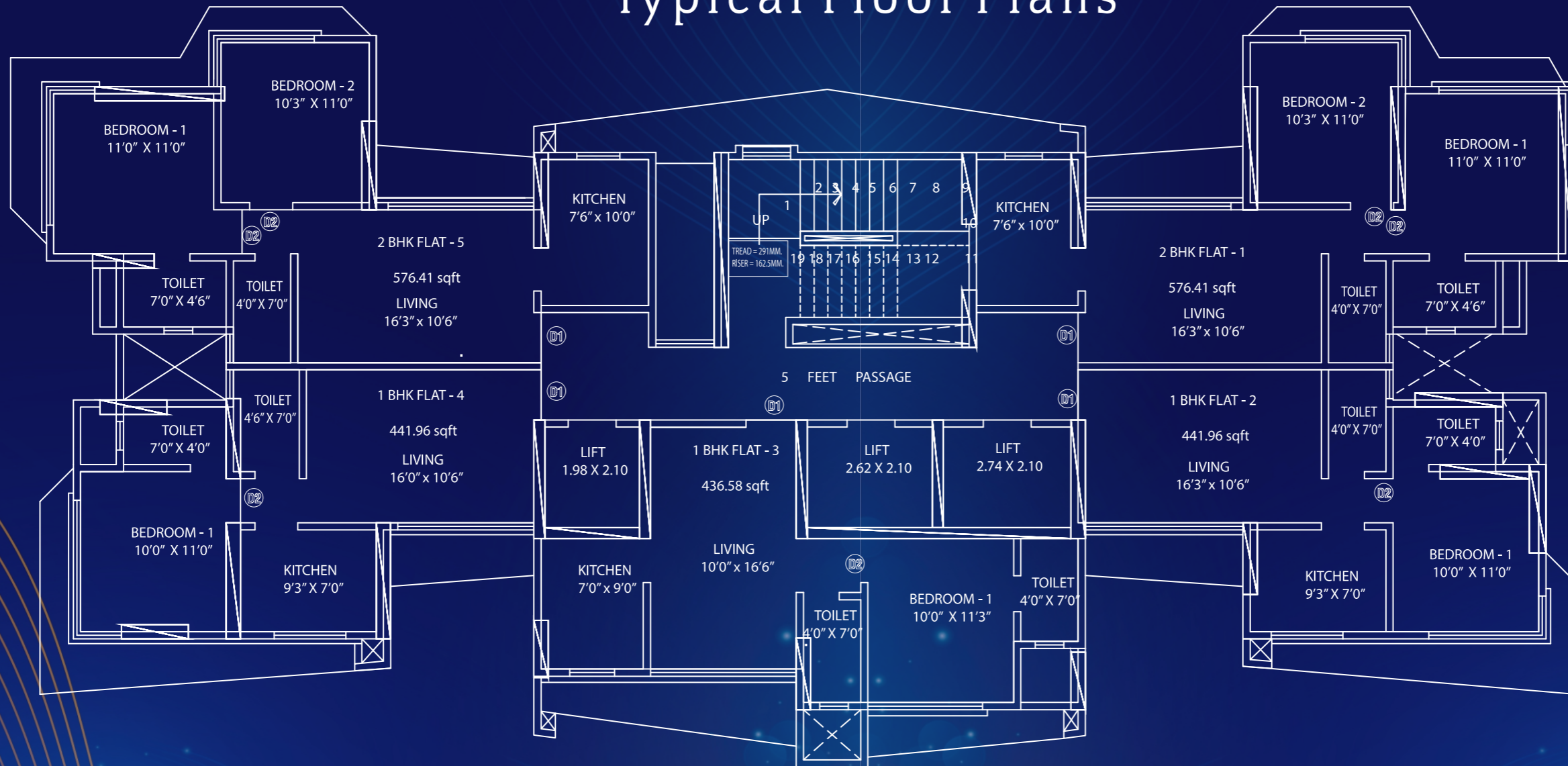

1 BHK  
Carpet Area 441.96 Sq.Ft.



2 BHK  
Carpet Area 576.31 Sq.Ft.

*Children  
Play Area*



*Health Club*



*Senior Citizen Seating Area*



*Pool Table*



*Parking*



*Carrom*



Image Representation not a actual image

Image Representation not a actual image

## LOCATION PLAN



- Near Malad Railway Station • Two minutes drive from link Road & S.V. Road
- Proposed Metro Railway Station 4 mins • Schools • Colleges • Gardens • Hospitals
- Places of worship in Neighborhood • Malls & Markets within easy reach

Site Address: **Shreeji Aspire**, CTS Nos 1 (Part) & 2 (Part) Village Valnai,  
Malad (West), Mumbai - 400 064



Maha RERA Registration No. P51800003919  
<https://maharera.mahaonline.gov.in>



**SHREEJI**  
GROUP  
Building Bonds of Trust