

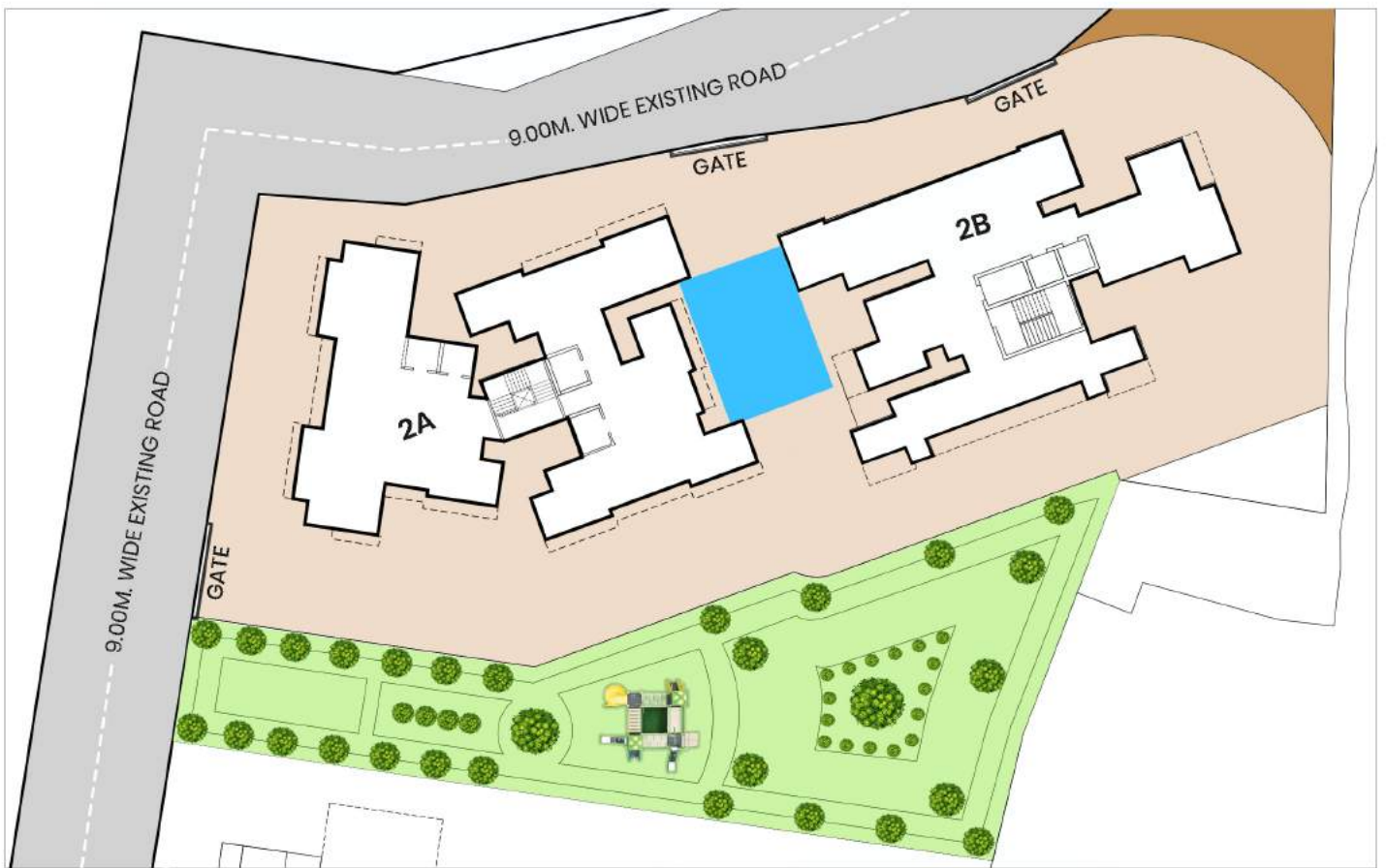

MAULI OMKAR



LAYOUT MAULI OMKAR BLDG 2B



MAULI OMKAR 2B



TYPICAL FLOOR PLAN BLDG. 2B



FOREST

ROAD

3D FLOOR PLAN



■ 1 BHK (415 SQ FT)



■ 1 BHK (394 SQ FT)

3D FLOOR PLAN



1 BHK (290 SQ FT)



2 BHK (571 SQ FT)

Ultra Modern Amenities



Gymnasium



Swimming Pool



Garden

All Image Used For Representation only*



Children Play Area

Connectivity & Features

- 05 Min From Western Express Highway
 - 05 Min From Pushpa Park Metro Station
 - 02 Min From Malls & School
 - 10 Min From Malad Railway Station
 - Adjacent to Sanjay Gandhi National Park
-



(LOCATION MAP)