

B C CORP  
**arista**

RERA No. P51800046486

1/19



**Live Exemplary**

# Not Just

**A STRUCTURE MADE OF BRICK AND MORTAR; WE UNDERSTAND THAT YOUR HOME IS THE OUTCOME OF YOUR LIFE'S WORK**

We are a team of like-minded professionals who have come together with a sole focus to create our own, distinct identity in the real estate sector. Currently we are focusing on making a mark mainly in the Real Estate Industry of Mumbai. As a young, motivated organization B C Corp is driven strongly by its set of work ethics and philosophy. The group believes in two important values - zero compromise on quality and timely execution of each project as per its promised schedule. Armed with strong values and a purposeful vision, B C Corp team is working every day to construct that very promising future for you and your family. !



# The Project

A perfect setting for living your remarkable success story. Welcome to B C Corp ARISTA, for those who have truly arrived. Arista comprises of A and B wings, offering variable apartment sizes and use of area, viable for today's family needs. Set in Bandra East, a vibrant, modern part of the city, this landmark address is for those who are looking to enjoy the spoils of success. Magnus' close proximity to BKC allows one to enjoy excellent connectivity with WEH and EEH, good networking opportunities and access to exceptional recreational zones like the recently launched Jio World Drive (BKC)

# 20 STOREY BUILDING

Gr. + 3 podium

4th Level Amenity floor

5th to 20th 1 1/2, 2 and 3 BHK apartments

| Wing | Name      | Apt.Type     | RERA carpet area |
|------|-----------|--------------|------------------|
| A    | 1 1/2 BHK | Dream        | 415 sq. ft.      |
| A    | 2 BHK     | Premium      | 535 sq. ft.      |
| B    | 2 BHK     | Premium Plus | 664 sq. ft.      |
| B    | 3 BHK     | Luxury       | 930 sq. ft.      |

## AMENITIES

Garden, Walking Track, Swimming pool, Gym,

Kids Play Area, Party Hall with Entertainment Lounge.

## DISTANCE

5 min. to Bandra Railway Station

10 min. to Domestic Airport

15 min. to International Airport

10 min. to BKC

10 min. to Sea link

20 min. to South Mumbai



To North Mumbai  
WESTERN EXPRESS HIGHWAY  
KALANAGAR FLYOVER  
To South Mumbai



Ground Floor

To South Mumbai  
WESTERN EXPRESS HIGHWAY  
KALANAGAR FLYOVER  
To North Mumbai

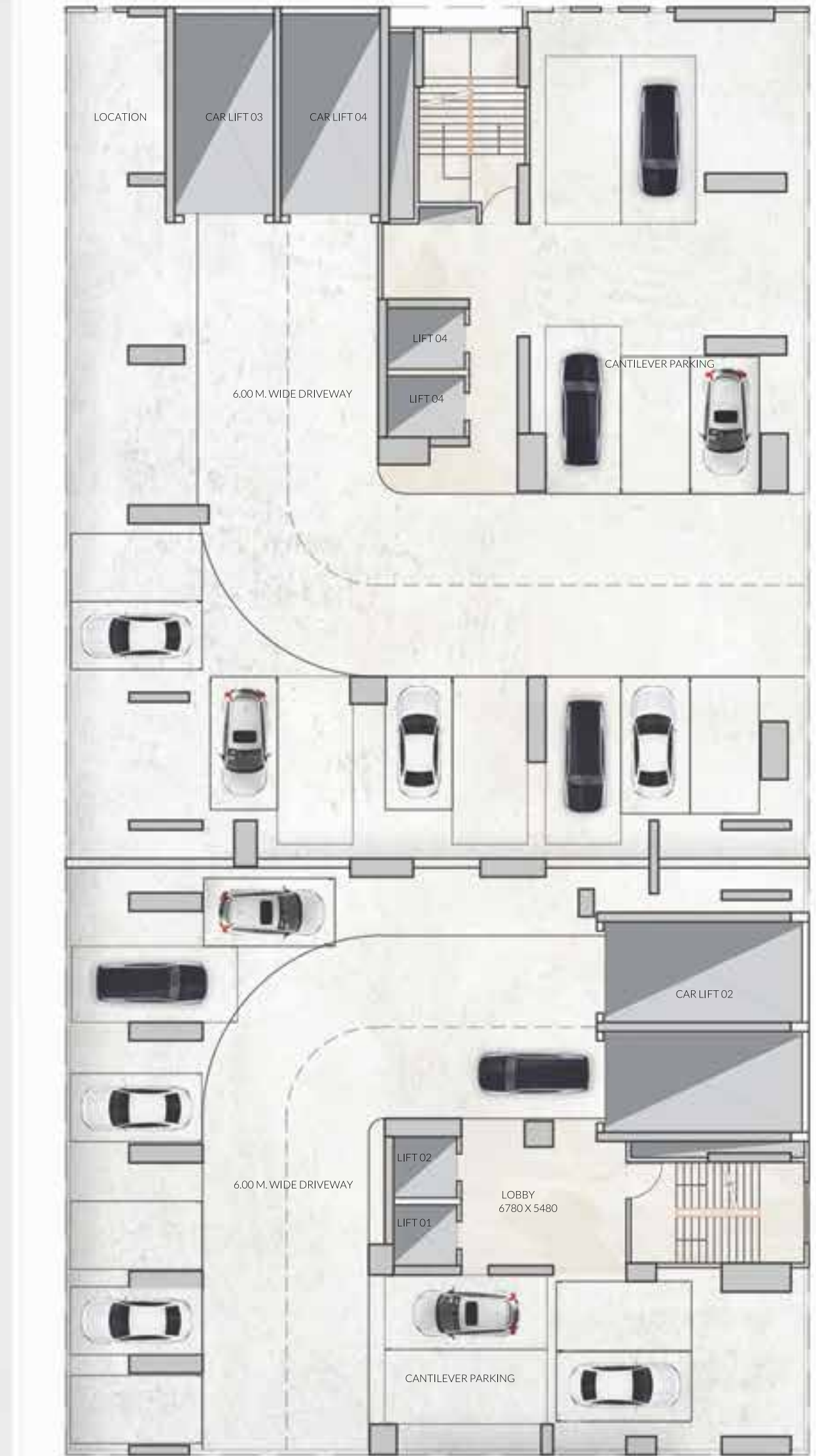

Podium Plan



Grand Entrance lobby



To North Mumbai ← WESTERN EXPRESS HIGHWAY KALANAGAR FLYOVER → To South Mumbai



# Amenity Floor Plan





Swimming pool with deck



Party Hall



Full Car Park E.V. Ready



Gym



Kids Play Area

PODIUM LINE BELOW



# Typical Floor Layout

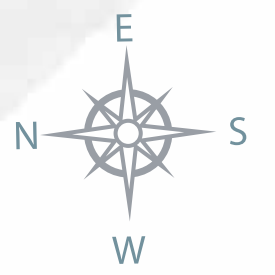

## PROJECT FEATURES

- ▶ High speed elevators
- ▶ Total number of floors planned : 20 floors.
- ▶ Well planned apartments of 1 1/2, 2 and 3 BHKS
- ▶ Italian marble entrance lobby
- ▶ 3 Podium level car park
- ▶ All car park future ready for electric vehicals.
- ▶ Appartments designed for new age familites
- ▶ Jodi option available
- ▶ Environment compliant project
- ▶ Fire protection systems as per CFO norms.
- ▶ Earthquake resistance structure.
- ▶ CCTV surveillanc cameras
- ▶ Ample covered car and bike parking
- ▶ 4 Car lifts





**Dream 1 1/2 Bhk Plan**  
 RERA CARPET : 415 sq. ft.

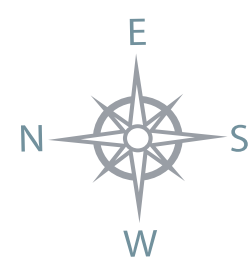



**Luxury 3 Bhk Plan**  
 RERA CARPET : 930 sq. ft.

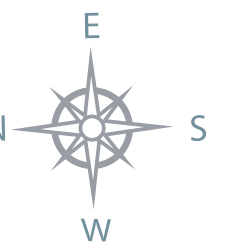



**Premium 2 Bhk Plan**  
A Wing RERA CARPET :535 sq. ft.

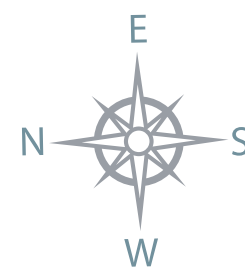

**Premium Plus 2 Bhk Plan**  
B Wing RERA CARPET :664 sq. ft.





To North Mumbai ← WESTERN EXPRESS HIGHWAY KALANAGAR FLYOVER → To South Mumbai



# Terrace Floor Plan

- 1. JOGGING TRACK
- 3. PARTY LAWN
- 5. WEST SKY OBSERVATORY ONE
- 7. FOUNFOUNTAIN
- 9. TOILET
- 2. BBQ COUNTER
- 4. HOSTING DECK
- 6. WEST SKY OBSERVATORY TWO
- 8. SEATING AREA
- 10. SEATING CORNER





arista

## AREA FINISHES

- 4' x 2' ceramic tiles for all areas of the house
- Master bedroom will be in wooden ceramic tiles
- All finish will be in Gypsum
- Bathroom will be in co-ordinated ceramic tiles
- All common areas will be in anti skid ceramic tiles
- Windows will be polymer powder coated
- Glass will be clear 5mm
- All CP fixtures will be of premium quality
- All hardware will be good quality
- Pool will be glass mosaic finish
- Gym will be fitted out with the latest equipment
- Elevators will be Schindler/ Kone or equivalent with brushed SS finish
- All electricals will be ISI standard and all wiring will be polycab
- The entire building will be landscaped

## PROJECT ASSOCIATES

Developer

**B. C. Corp.**

Design Consultant

**Irani Architects**

Structural Consultants

**J. W. Consultants**

Architect on Record

**YES Realty**

## THANK YOU !

Arista team ensures a legacy of exuberance with world class facilities and uncompromised quality.

