



TIARA

YOU DESERVE THE

Best

Dominic Colony, Malad(W).



TRIARA
CHSL

Project By
PCPL





TIARA

Situated at 2nd Dominic colony lane, Malad west is all set to get a facelift thanks to Tiara by PCPL. Being redeveloped as a 10 floor residential complex with a host of amenities, Tiara brings you the best of comfort and convenience, giving you a perfect home to own in one of Mumbai's top locations.

Spacious and well-designed 1 & 2 bed houses in a gated community with a **barbeque area, a dedicated space for senior citizens to rest and catch up, a toddler play area, and a beautiful walking pathway** make it a home worth coming

to. And this is made possible quicker, because of its seamless connectivity to **schools, hospitals, churches, railway stations, and metro rail**, all under 3 km!

A project that's rapidly progressing.

Tiara CHSL comes with the experience, trust, uncompromised quality, and timely delivery of PCPL, who's been giving thousands of Mumbaikars their dream home, for over a decade.





BARBEQUE AREA



TIARA

TODDLER PLAY AREA



TIARA

WALKING PATHWAY



TIARA

SENIOR CITIZEN SITTING AREA

TYPICAL FLOOR PLAN



FLAT CONFIGURATION

1 BHK : 407 sq.ft., 443 sq.ft., 467 sq.ft., 470 sq.ft.

2 BHK : 584 sq.ft., 630 sq.ft., 634 sq.ft., 636 sq.ft., 643 sq.ft.

Drawings are not to scale.

Drawings are subject to change by the local authorities.

GROUND FLOOR PLAN



Drawings are not to scale.
 Drawings are subject to change by the local authorities.

TERRACE FLOOR PLAN

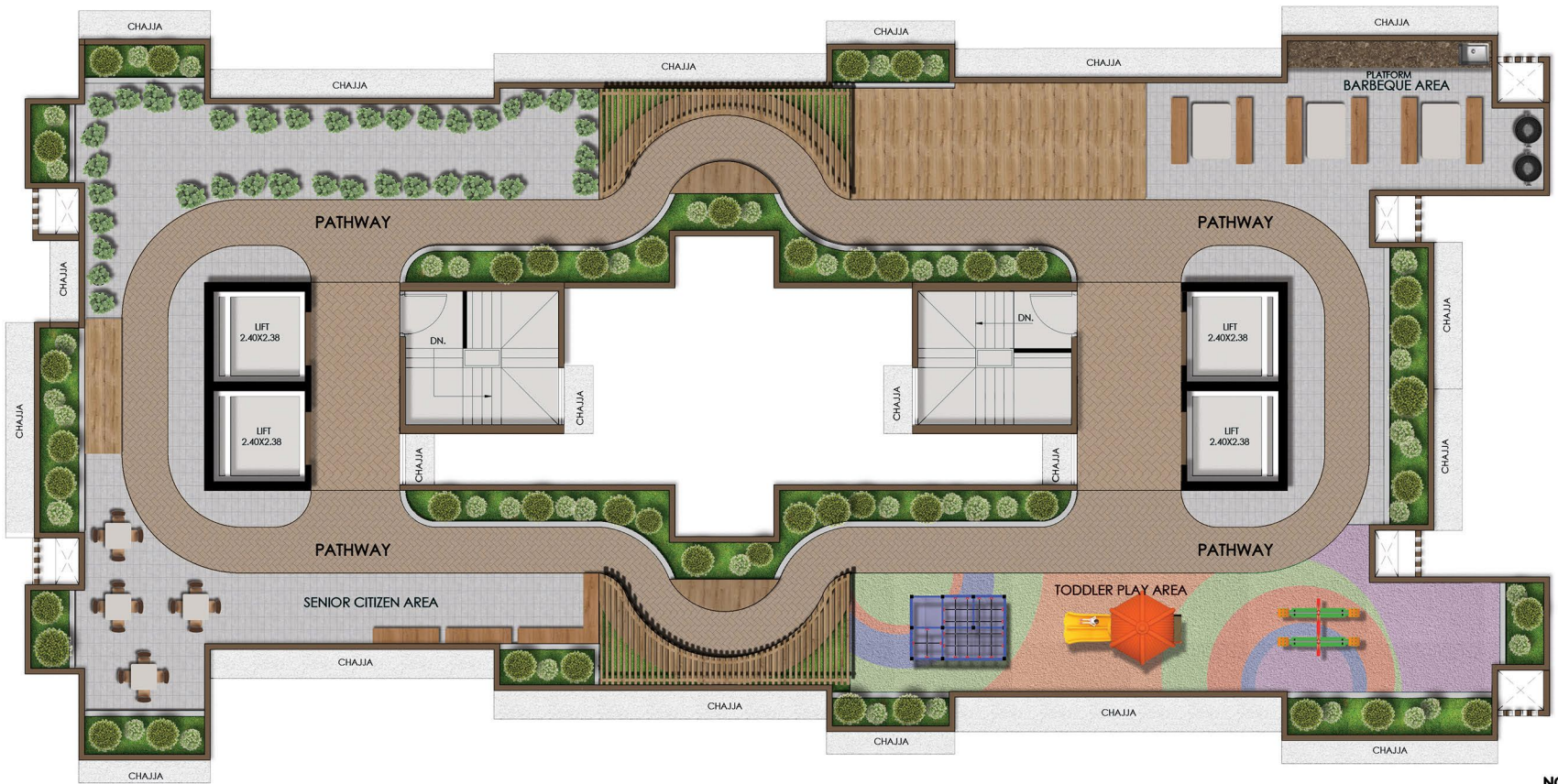



Drawings are not to scale.
Drawings are subject to change by the local authorities.

CONVINIENCE GUARANTEED

- 

Malad Railway Station - **2.1 km**
- 

Kandivali Railway Station - **2.1 km**
- 

Orlem Church - **400 mtrs**
- 

St. Anne's High School & Junior College - **400 mtrs**
- 

Liberty Garden - **1.6 km**
- 

Thunga Hospital - **1.3 km**
- 

Infiniti Mall - **2 km**

LOCATION MAP

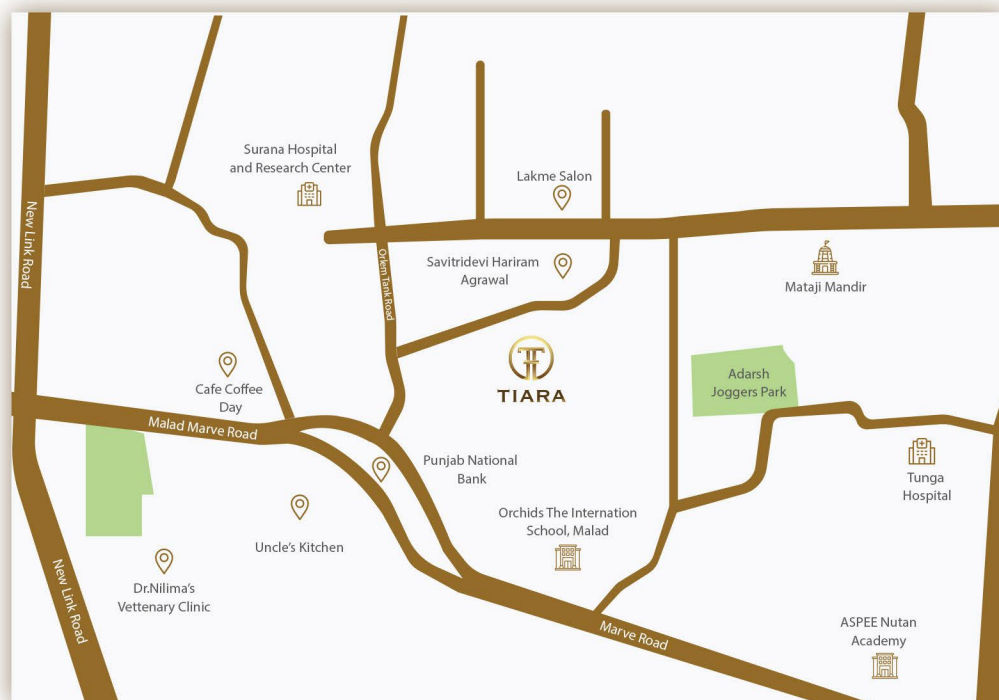

Site Address;

2nd Dominic Colony Lane, Orlem, Malad (West), Mumbai 400064.