

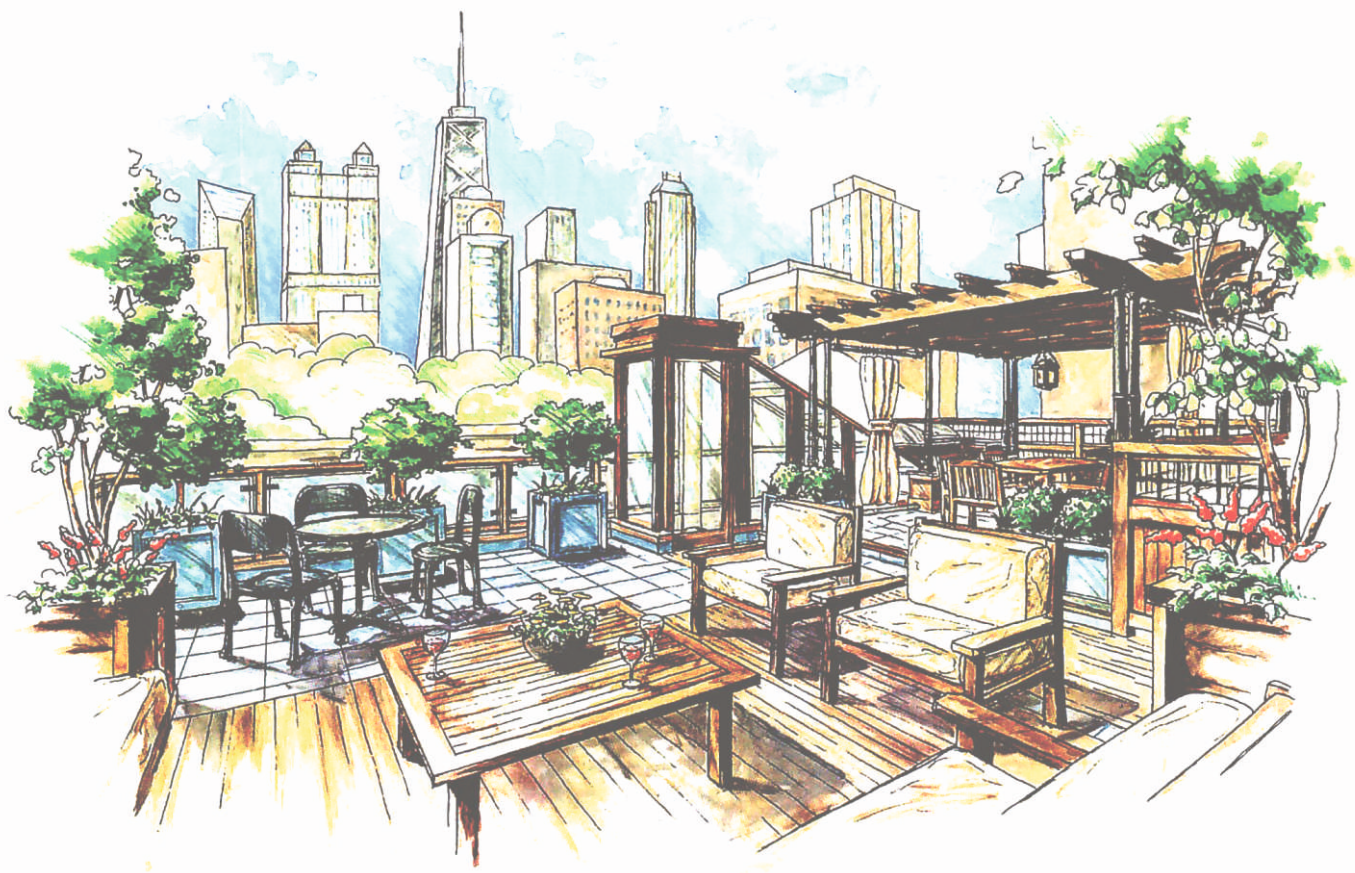

Where Dreams Become Reality



MAHA RERA REGISTRATION
P51800017307

8 Floors of Commercial Space



Features

As you step into the building you are greeted with grandeur & elegance. A grand lobby boasting with flawless Italian marble, welcomes you & your guests. Your home is a clear reflection of your discerning taste. Planned to perfection & built to suit your lifestyle at **“KCD LUMIN”** you will discover a host of Exquisite Comforts.

Amenities

- Ground + 20 Storey Building.
- Commercial / Residential.
- Exterior Waterproof Paint.
- Fire Detector & Fire Fighting System.
- Ample User Friendly Parking.
- Wifi Enabled Building.
- Granite Platform with S.S. Sink.
- Elevators of Superior Brand.
- Equipped Society Office / Library Lounge.
- Video Door Phone.
- Vitrified Tiles.
- Lavish Entrance Lobby.
- Gymnasium / Yoga Bay.
- Modular Kitchen.
- Rooftop Garden.





Standing tall amongst its peers, “**KCD LUMIN**” encompasses 20 storeyed towers exuding a class beyond compare. Thoughtfully equipped with a host of modern amenities, the project reflects the best urban living can offer.

“**KCD LUMIN**” is a residential development with an enviable location on M.G. Road in Kandivali West Mumbai being located in a developed neighborhood. Your new home can be in the vicinity of social infrastructure such as Banks, Restaurants, Supermarkets, Hospitals, Parks and various other recreational places.

What's more, get easy access to the Link Road, S.V. Road and the proposed Mumbai Metro which will ease your commute to other areas of the city.