

C O D E N A M E

**Bl**iss *life*

A N D H E R I W E S T

# Welcome to A Blissful Life!

---

Zee Land Development Services have constructed many projects which are towering the city of Mumbai and empowering its citizens with homes that they could only dream of. We have built strong relations with our customers and our own people too. That's why we boast of a dedicated team of professionals enriched with decades of expertise and passion that has no equal.

Nestled in the heart of Andheri West, a suburb that has its own magnetic charm and bliss, now proudly will have another feather in its hat when it comes to unparalleled quality of homes.

One such project is Codename Bliss Life. This project is truly a vision of Project Architect - Mr. Ashish Solanki which promises prosperity to those who live here and unity amongst its future residents. This 16 storey tower, offers **1, 2 & 4 BHK homes** ideal for those restless citizens who push the levels of excellence in their professional lives and also strive to match it with quality lifestyle.





ARTISTIC IMPRESSION

Disclaimer: Floor plan is for marketing purpose and is to be used as a guide only. Floor plan is intended to give a general indication of the proposed floor layout only and may vary in the finished building. All drawings/dimensions shown are for illustrative purposes only and may not be an accurate representation of final construction and are not intended to form part of any contract or warranty unless specifically incorporated in writing into the contract. Please ask our sales advisor for details of the treatments specified for individual Premises/Offices/Shops.





# The luxury that keeps you ahead

With the ever increasing need for space and a zeal to own the best, we know what modern home owners yearn for. So to hold true to our word of improved lifestyle and enhanced living, we rejoice in delivering efficiently reimagined home spaces that boast a smooth way of life. And making it picture perfect are the finest amenities and facilities seamlessly integrated throughout the project to compliment a bliss life.



# Project Hallmarks

## STRUCTURE

Earthquake resistant well planned structure in a prime location of Andheri West

## LOBBY

Well planned designer entrance lobby.

## FLOORING

Elegant good quality Vitrified tiles along with skirting in entire flat.

## WINDOW

Powder coated Aluminum sliding windows with Marble / Granite sill.

## DOOR

Decorative laminated main flush door with good quality brass fitting.

## KITCHEN

Kitchen cabinet  
Granite platform  
Complete tiling till beam  
Water Purifier

## TOILET

Geyser in all toilets. Branded sanitary ware, fittings and fixtures. Designer ceramic tiles upto beam level. Concealed plumbing.

## ELECTRICAL

Concealed heavy duty copper wiring, adequate points with modular switches. T.V., Telephone, Internet points and AC points in Living room and Bedrooms.

## INDOOR PAINT

Gypsum finished plaster  
Plastic paint in entire flat.

## OUTDOOR PAINT

Damp proof outdoor paint.

## LIFT

Stainless Steel, hi-speed lifts of branded company.

## SECURITY

Hi-tech 24X7 security systems with CCTV cameras, Intercom phone

## PARKING

Ample parking space

## Additional Features

Huge entrance lobby  
Gymnasium  
Terrace recreation area  
Walking track

ARTISTIC IMPRESSION





# Enjoy Bless life in every step!

## Blissful Amenities



Disclaimer: Floor plan is for marketing purpose and is to be used as a guide only. Floor plan is intended to give a general indication of the proposed floor layout only and may vary in the finished building. All drawings/dimensions shown are for illustrative purposes only and may not be an accurate representation of final construction and are not intended to form part of any contract or warranty unless specifically incorporated in writing into the contract. Please ask our sales advisor for details of the treatments specified for individual Premises/Offices/Shops.





Gymnasium



Sky Lounge



Yoga/Meditation Area



Jogging/Walking Track



Senior Citizen Area



Terrace Garden



**UPGRADE FOR THE BLISS LIFE**





A home is much more than just the walls within which you reside. So come and bliss yourself in our beautifully planned open area with modern life spaces like gym, rooftop garden where memories and moments of deep pleasure and happiness merge to promise an attractive way of bliss life.



ENTRANCE LOBBY

ARTISTIC IMPRESSION



GYMNASIUM

ARTISTIC IMPRESSION



SENIOR CITIZEN SEATING

STOCK IMAGES



# Get everything at walkable!

## Location Advantages





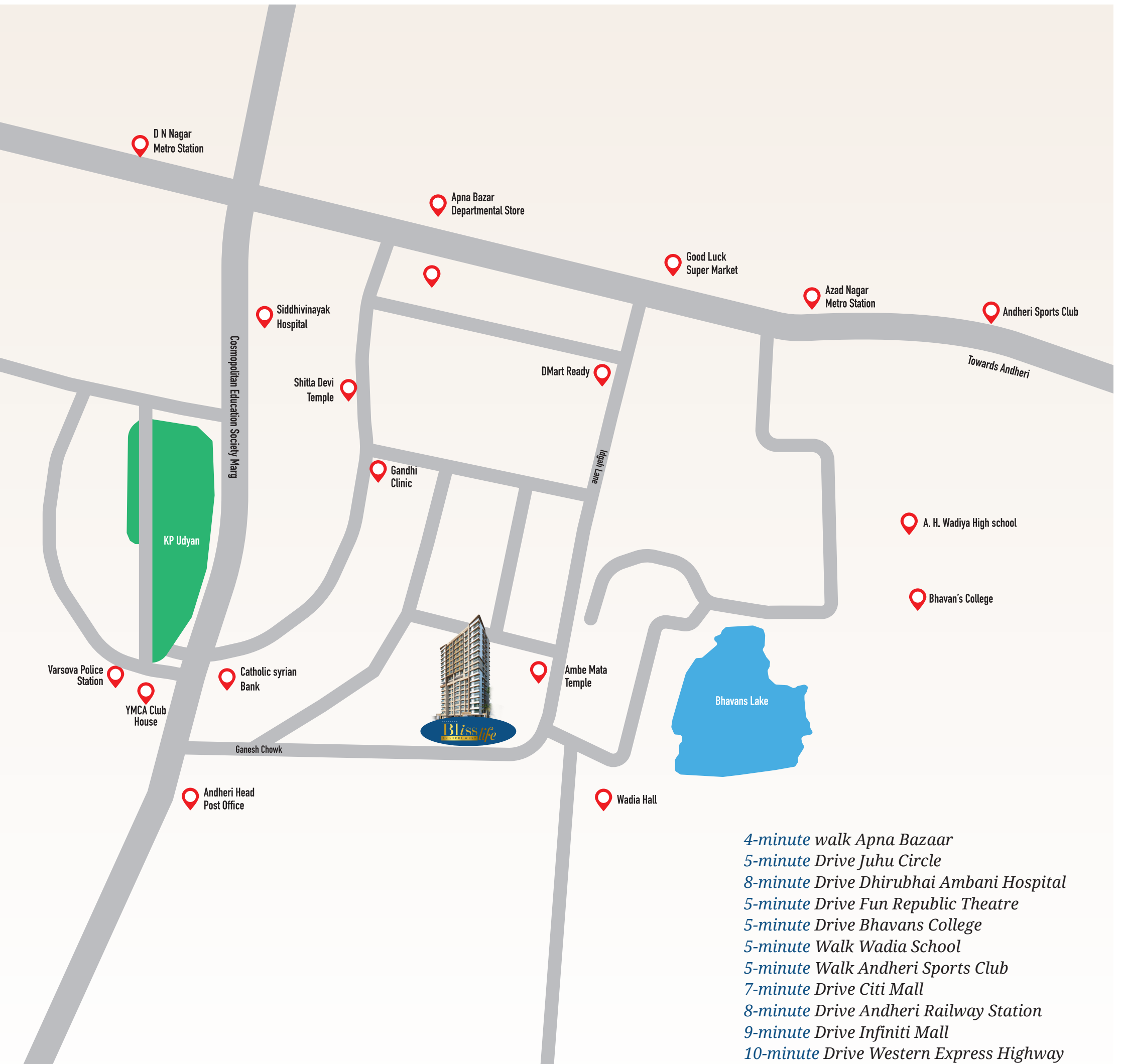

- 4-minute walk Apna Bazaar*
- 5-minute Drive Juhu Circle*
- 8-minute Drive Dhirubhai Ambani Hospital*
- 5-minute Drive Fun Republic Theatre*
- 5-minute Drive Bhavans College*
- 5-minute Walk Wadia School*
- 5-minute Walk Andheri Sports Club*
- 7-minute Drive Citi Mall*
- 8-minute Drive Andheri Railway Station*
- 9-minute Drive Infiniti Mall*
- 10-minute Drive Western Express Highway*



# Typical Floor Plan

10<sup>th</sup> to 16<sup>th</sup> Floor

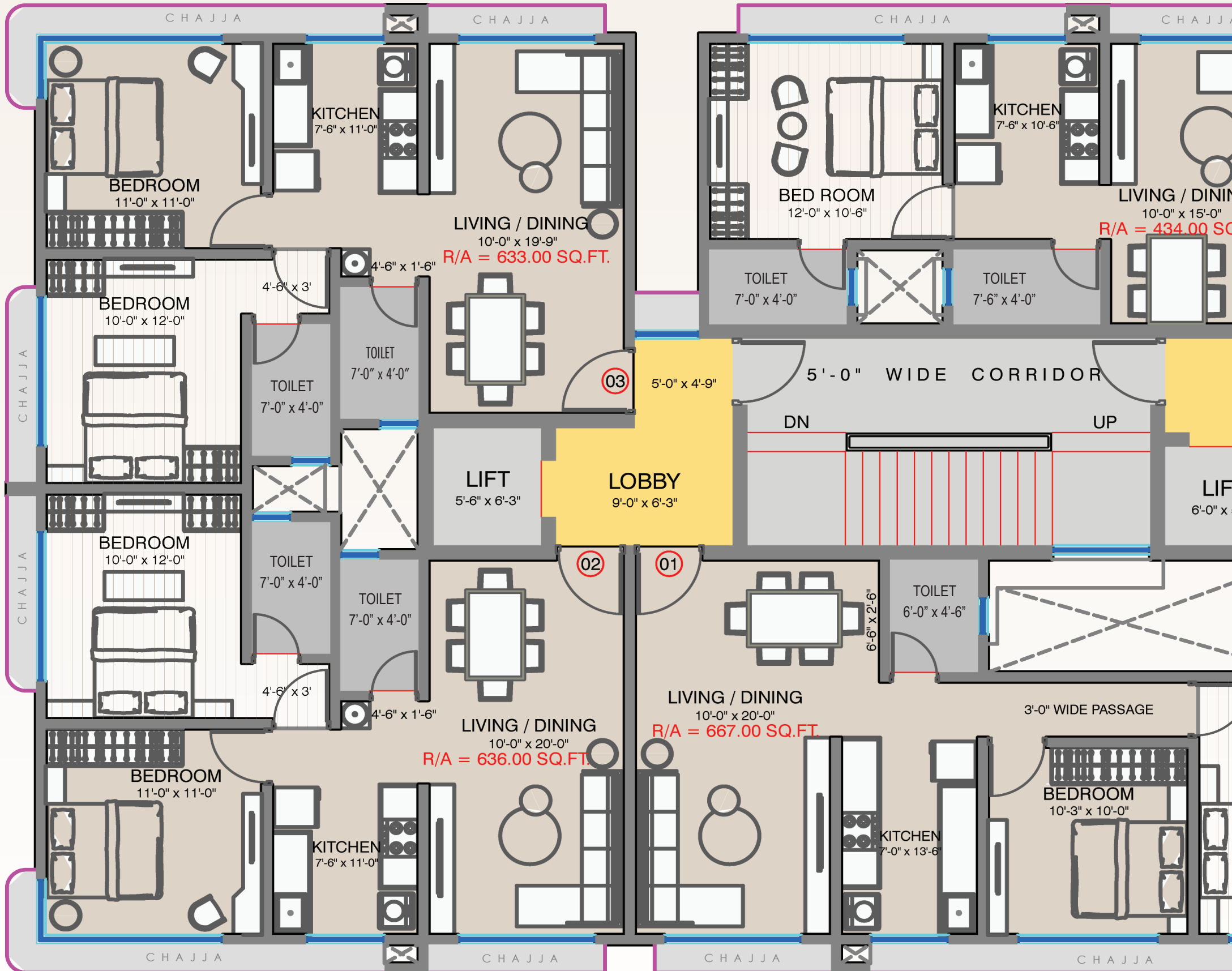

Disclaimer: Floor plan is for marketing purpose and is to be used as a guide only. Floor plan is intended to give a general indication of the proposed floor layout only and may vary in the finished building. All drawings/dimensions shown are for illustrative purposes only and may not be an accurate representation of final construction and are not intended to form part of any contract or warranty unless specifically incorporated in writing into the contract. Please ask our sales advisor for details of the treatments specified for individual Premises/Offices/Shops.



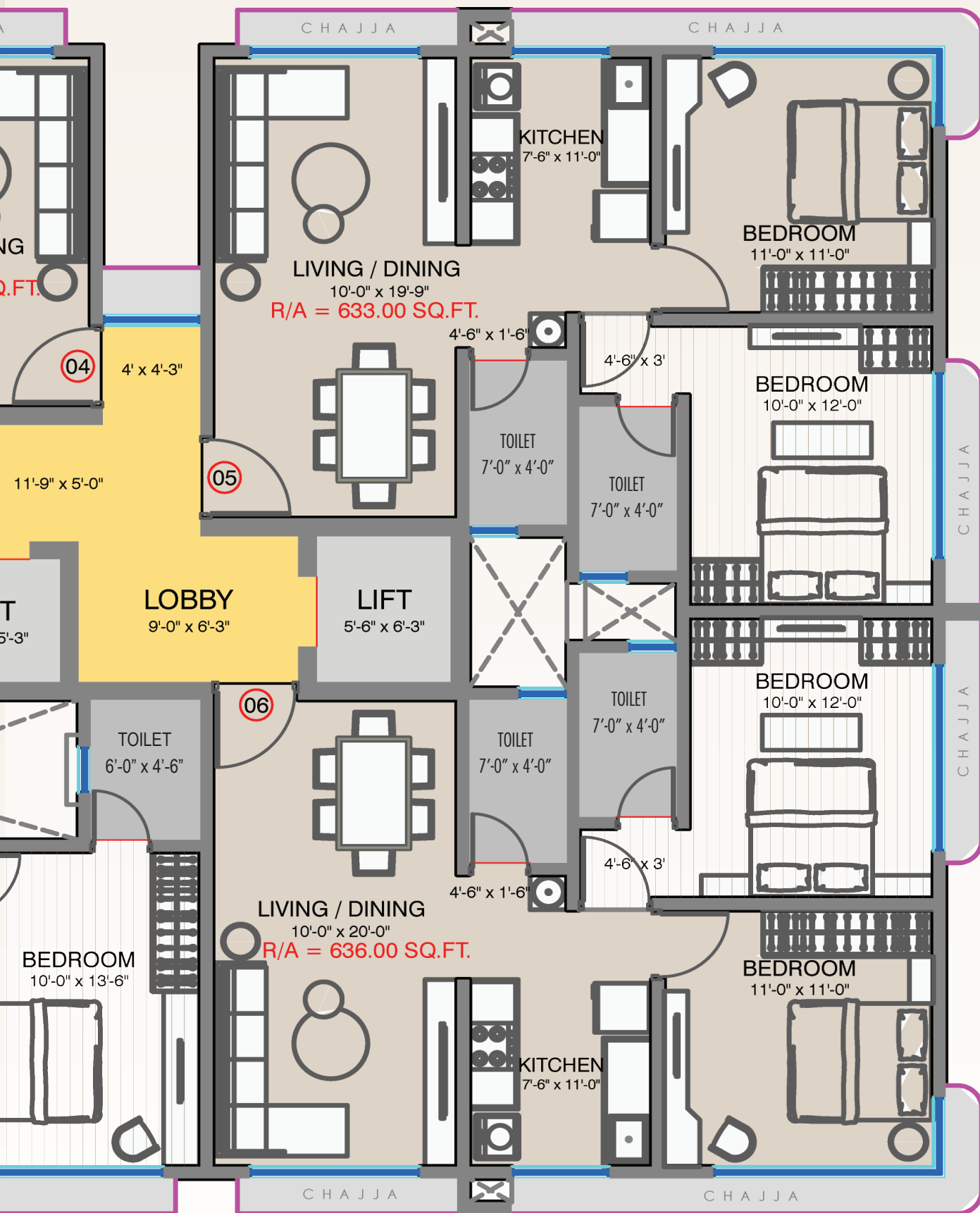

RERA CARPET STATEMENT - WING A

S.No.	DESCRIPTION	AREA
1	1 BHK	434 Sq.ft
2	2 BHK	633 / 636 / 667 Sq.ft
3	2+2 Jodi	1310 Sq.ft

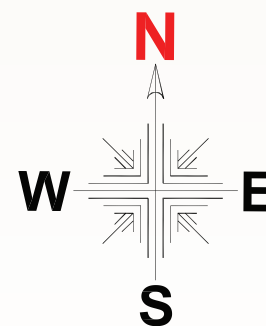



# Where opulence meet excellence...

## A Blissful Life!

When you enter your home at Bliss Life, you enter into a world of peace, tranquility and a lifestyle that will give you the feels. It's worth the money for sure, but more than that, it's worth giving the life you want for yourself and your family. Everything is designed to suit your needs and wants. A welcome life no other!

Step inside your home and brace yourselves for a beautiful world. With the best quality ingredients that go into making your home look more spacious.

The state-of-the-art plumbing and gas installation, that premium window framing, the smooth sliding windows opening up to a panoramic view of the city will give you that feeling that you have arrived in life.

But there is more!







ARTISTIC IMPRESSION

Disclaimer: Floor plan is for marketing purpose and is to be used as a guide only. Floor plan is intended to give a general indication of the proposed floor layout only and may vary in the finished building. All drawings/dimensions shown are for illustrative purposes only and may not be an accurate representation of final construction and are not intended to form part of any contract or warranty unless specifically incorporated in writing into the contract. Please ask our sales advisor for details of the treatments specified for individual Premises/Offices/Shops.