



ELEVATE TO
THE NEXT LEVEL



MahaRERA Registration No. P51800007630 | www.maharera.mahaonline.gov.in | www.mumbaixl.in

Disclaimer: The information and material contained in this brochure pertain to the real estate project "Ruparel West Sky" also known as "Mumbai XL" ("said Project") registered with Maharashtra Real Estate Regulatory Authority under Registration No. P51800007630 and is available on the website - www.maharera.mahaonline.gov.in. The photographs, images, videos, plans, drawings, sketches, renderings, pictorial and graphical representations, specifications, illustrations, other information etc. contained in the brochure are typical stock/standard photography used by the industry at large and/or pure imagination, and are intended to indicate a conceptual and aspirational lifestyle. None of the aforementioned are indicative of how the Project or any part thereof looks at present and/or may eventually look in future and/or may be designed, constructed and/or completed. Fixtures and furnishings shown are only for indicative purpose and shall not be provided in the apartment. The views, landscape, aerial shots contained in this brochure or any other sales material are also from typical stock/standard photography. The information and material contained in this brochure are intended to supplement the information available on the website of MahaRERA and is not intended to be a substitute thereto. Any person who is considering/evaluating any apartment in any of the registered real estate projects in the Project, are required to independently analyse, acquaint and familiarise themselves with the information and disclosures pertaining to the Project as uploaded on the website of MahaRERA. In the event of any conflict (whether actual or perceived) between the information and material contained in this brochure and the details of the Project available on the website of MahaRERA, the details as available on the website of MahaRERA shall prevail. The buildings and projects appearing in the images of Kandivali and constructed in the vicinity of the locality of the Project are constructed by various other persons who are not connected with the Developer. These images are included so that any person gets a fair idea of the landscape in and around the general macro-region of the Project. Any person considering/evaluating any apartment in any of the Project, should visit the site and land of the Project and ascertain the layout, views, landscape and other aspects as he/she/it/they may deem important or required. Any such person must also evaluate and examine all information required to be disclosed under law. The Project is part of a SRA Scheme. The Developer expressly reserves the right to make modifications, revisions, amendments, relocations substitutions and/or withdrawals with respect to any facet or component of the Project, including as depicted in any information or material contained in this brochure, in the manner it may deem fit. The Developer expressly clarifies and makes it abundantly clear that the finalised details, specifications and particulars with respect to any facet or component of the Project (including as depicted or stated in this brochure) shall be as indicated in the registered agreement for sale that may be executed by the Developer and as disclosed by the Developer, and not otherwise. These printed material does not constitute an offer and / or contract of any type between the Developer and the recipient. Any purchaser of this development shall be governed by the terms and conditions of the agreement for sale entered into between the parties and no details mentioned in these printed material shall in any way govern such transaction. *T&C Apply.



LIFE SURPASSING
THE NEW HEIGHTS OF LUXURIES

Enter into the world of Ruparel Westsky and discover the epitome of luxury amidst the astonishing spaces. From the enthralling views of the city and nature to extravagant lifestyle experiences, homes here unveil sheer grandeur and splendour you have always imagined in your dreams. Come let your desires meet a place of serenity, sophistication and superlative lifestyle for every Mumbaikar who has made a mark in this maximum city. Welcome to Ruparel Westsky.



A WORLD THAT ASSURES NEXT LEVEL LIFE EXPERIENCES

NEXT LEVEL ► LIFESTYLE

It's a landmark with abundance of curated amenities that represent a premium lifestyle. The facilities are what you will find in large-scale townships and that are built keeping in mind every family member's needs.



Stock Image

◀ NEXT LEVEL SPACES

Experience the efficient layout, world-class finishes and fittings as well as cutting-edge technology that give you extra-large and spacious apartments with zero space wastage.



Stock Image

NEXT LEVEL CONNECTIVITY ►

Get the advantage of an established in-city neighbourhood in prime kandivali west thar is a stone's throw the metro station and less than 15 minutes from the key hubs in the region



Stock Image

NEXT LEVEL ► VALUE

Cherish the region's best priced spacious 2 Bed Residences at lowest maintenance costs, maximum rental yields and unbeatable investment benefits.



Stock Image

◀ NEXT LEVEL LUXURY

A part of the Group's chain of iconic projects designed to upgrade 10 million Mumbaikars; this iconic 59-storey tower is the tallest tower in Kandivali West and is set to become a landmark of not just Kandivali, but the whole of Mumbai.



Stock Image

◀ NEXT LEVEL COMMITMENT

Discover an iconic world of Ruparel Realty that comes with a promise of efficiency in construction and cutting-edge technologies that ensure you get the key to your home in record time.



Stock Image



SCALE NEW HEIGHTS
OF LUXURY
AT REGION'S
TALLEST LANDMARK



Artist's Impressions



EXPERIENCE THE WORLD
OF NEXT LEVEL LIVING

RUPAREL
WESTSKY
KANDIVALI - WEST

Project Hallmarks

- Iconic 59-storey tower that commands attention and pride alike
- Spacious 2 Bed residences with balcony and stunning views
- Club-class upper floor, dedicated to leisure, relaxation and entertainment
- Premium lift lobbies and hi-speed, branded elevator system
- Security and CCTV surveillance
- Retail and commercial spaces at ground level

RUPAREL ELARA

RUPAREL PALACIO

RUPAREL SKYGREENS

Location Map



KANDIVALI (WEST)
THE PRIME ADDRESS OF
WESTERN SUBURB
WITH COUNTLESS CONVENIENCES

Location Advantages

-  Kandivali is well-connected to the rest of Mumbai through New Link Road, SV Road and Western Express Highway
-  Geography-defining proposed Metro Rail project connecting Charkop - Bandra - Mankhurd and Dahisar
-  It has close proximity to the commercial hubs of Malad, Goregaon, Andheri and Kurla
-  Great connectivity to social infrastructures like colleges, restaurants, beaches, gardens, schools, hospitals and theatres
-  A thriving industrial ecosystem, dotted with the presence of giants like Associated Capsules and Mahindra & Mahindra
-  A cosmopolitan neighbourhood with a well-knit social fabric and a buzzing nightlife
-  The upcoming Coastal Road makes the commuting even easier



EXCELLENTLY CONNECTED LANDMARK
WITH A WORLD OF PRIVILEGES

30+ LIFESTYLE ▶

- Infiniti Mall
- Inorbit Mall
- Growel's 101 Mall
- Amusement Parks
- 5-Star Hotels
- Raghuleela Mall



Stock Image

◀ UNMATCHED
LOCATION ADVANTAGES

- Dahanukarwadi Metro Station: 2 minutes
- New Link Road: 2 minutes
- Kandivali Railway Station: 10 minutes
- Western Express Highway: 15 minutes
- Industrial Hubs: 5 minutes
- Under construction Coastal Road (Kandivali to Nariman Point): 10 minutes



Stock Image

◀ 25+ HEALTHCARE

- Seven Star Multi-Speciality Hospital
- Oscar Hospital
- Lotus Multispecialty Hospital
- Nobel Hospital
- Chavan Hospital

30+ SCHOOLS ▶

- Ryan International School
- Billabong International School
- Thakur Education Institute
- Atharva Management Institute
- ITI-B Institute



Stock Image

15+ SPORTS ▶

- Sachin Tendulkar Gymkhana MCA
- Poisar Gymkhana
- Goregaon Sports Complex
- Pramod Mahajan Sports Complex



Stock Image



REVEL IN THE SEAMLESS PANORAMA
OF NEXT LEVEL EXTRAVAGANCE

Sky-residences with One-of-a-kind Private Deck
(For Select Residences on Upper Floor)



ACTUAL SEA VIEW



THE HEIGHTS WITH
A VISION BEYOND HORIZON

Mesmerizing view of Sea, City and Golden Pagoda

ACTUAL CITY VIEW





DISCOVER LARGER THAN
LIFE EXPERIENCES
OF THE NEXT LEVEL LIFESTYLE

WORLD-CLASS LUXURY
INDULGENCES AT 19TH FLOOR

- Infinity Pool with Wooden Deck & Loungers
- Most Relaxing Massage Therapy Centre
- Refreshing Jacuzzi to Discover Soothe

Infinity Pool with Wooden Deck & Loungers

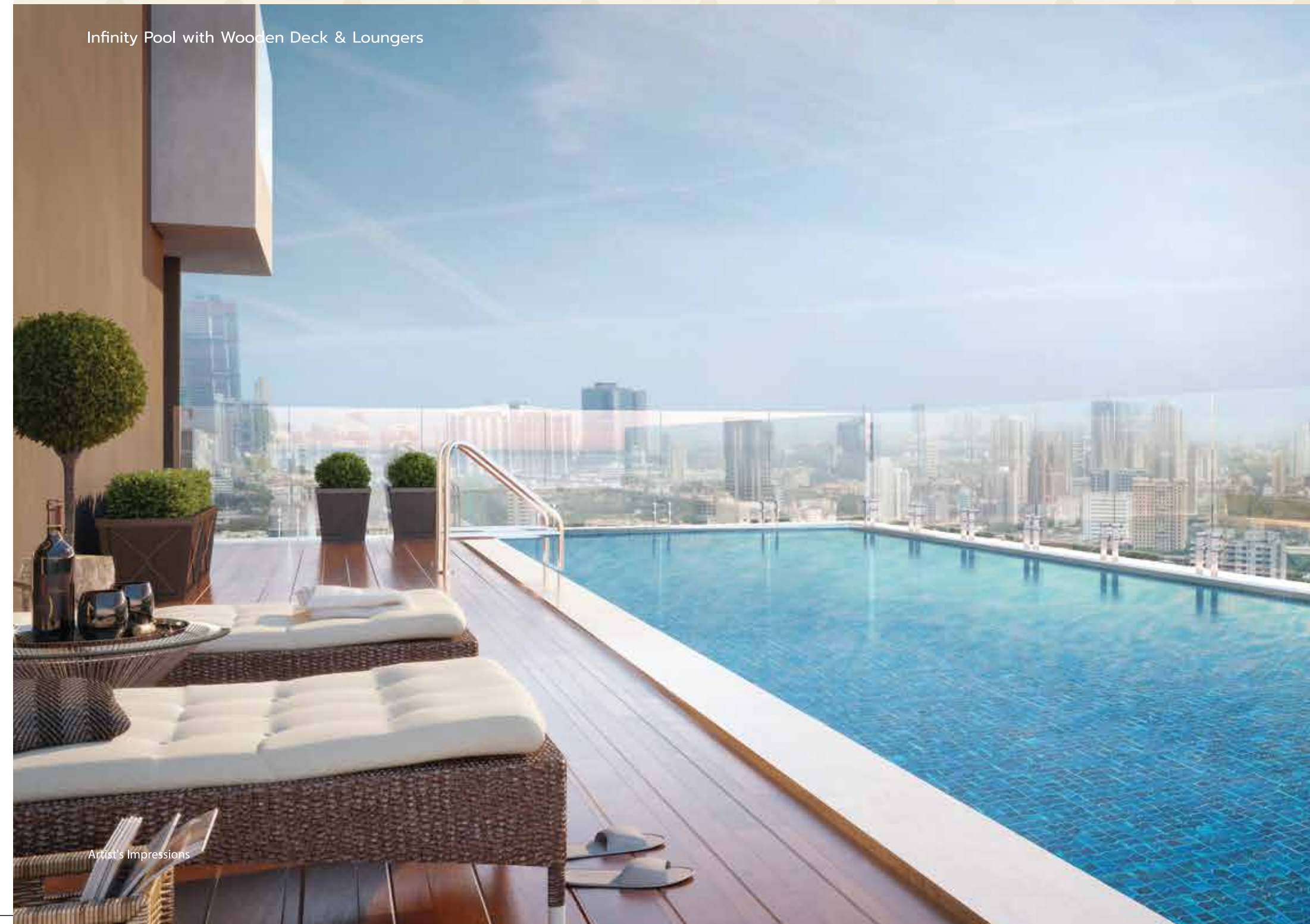

Artist's Impressions

Soul-rejuvenating Spa



Stock Image

Jacuzzi corner for a deep relaxation

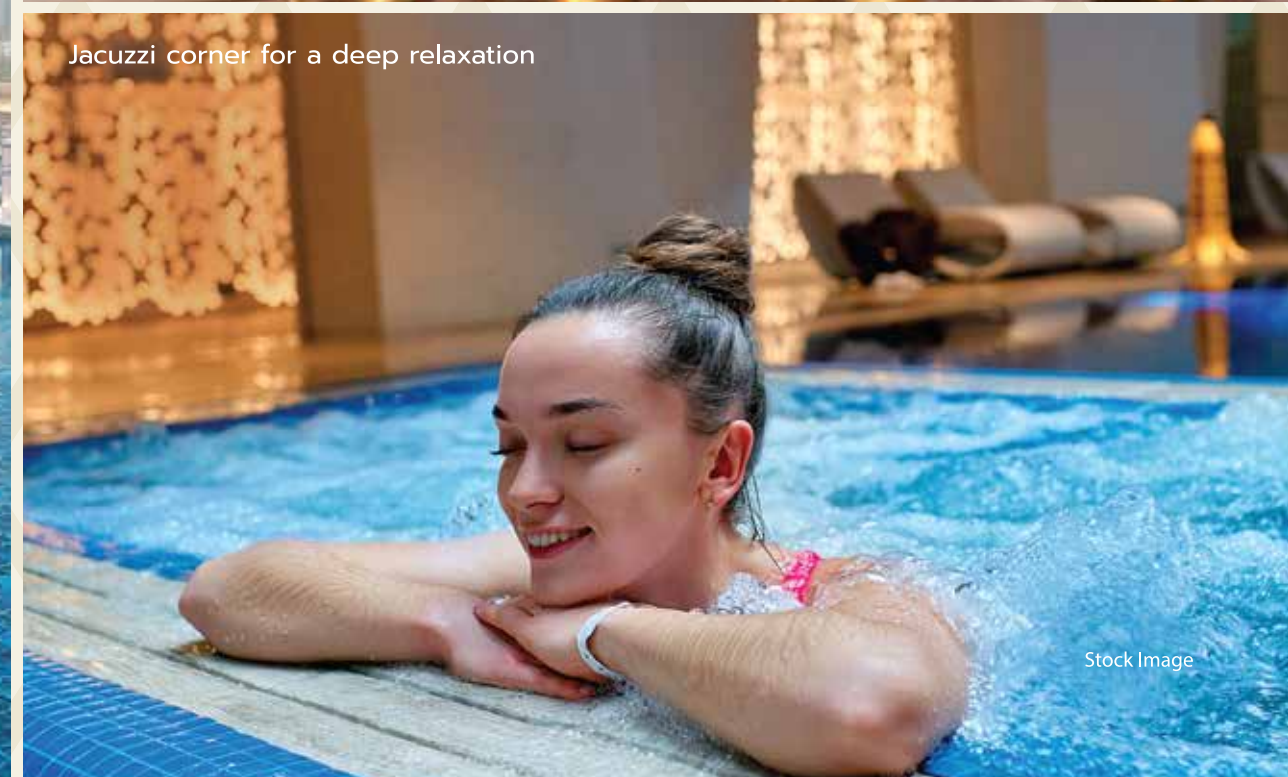

Stock Image

Children's Play Area with Modern Equipment



Artist's Impressions



**NEXT LEVEL ENGAGEMENTS
FOR JUNIORS AND SENIORS**

PLAY & LEISURE

- Children's Play Area with Modern Equipment
- Senior Citizen Zone with Sit-outs

Senior Citizen Zone with Sit-outs



Stock Image



INDULGE FOREVER
IN THE NEXT LEVEL

HEALTH AND RECREATION WORLD

HEALTH AND RECREATION

- World-class Fitness Centre
- Aerobics Room Yoga Room
- Indoor Games Arena with Table Tennis, Pool Table, Chess and More

World-class Fitness Centre

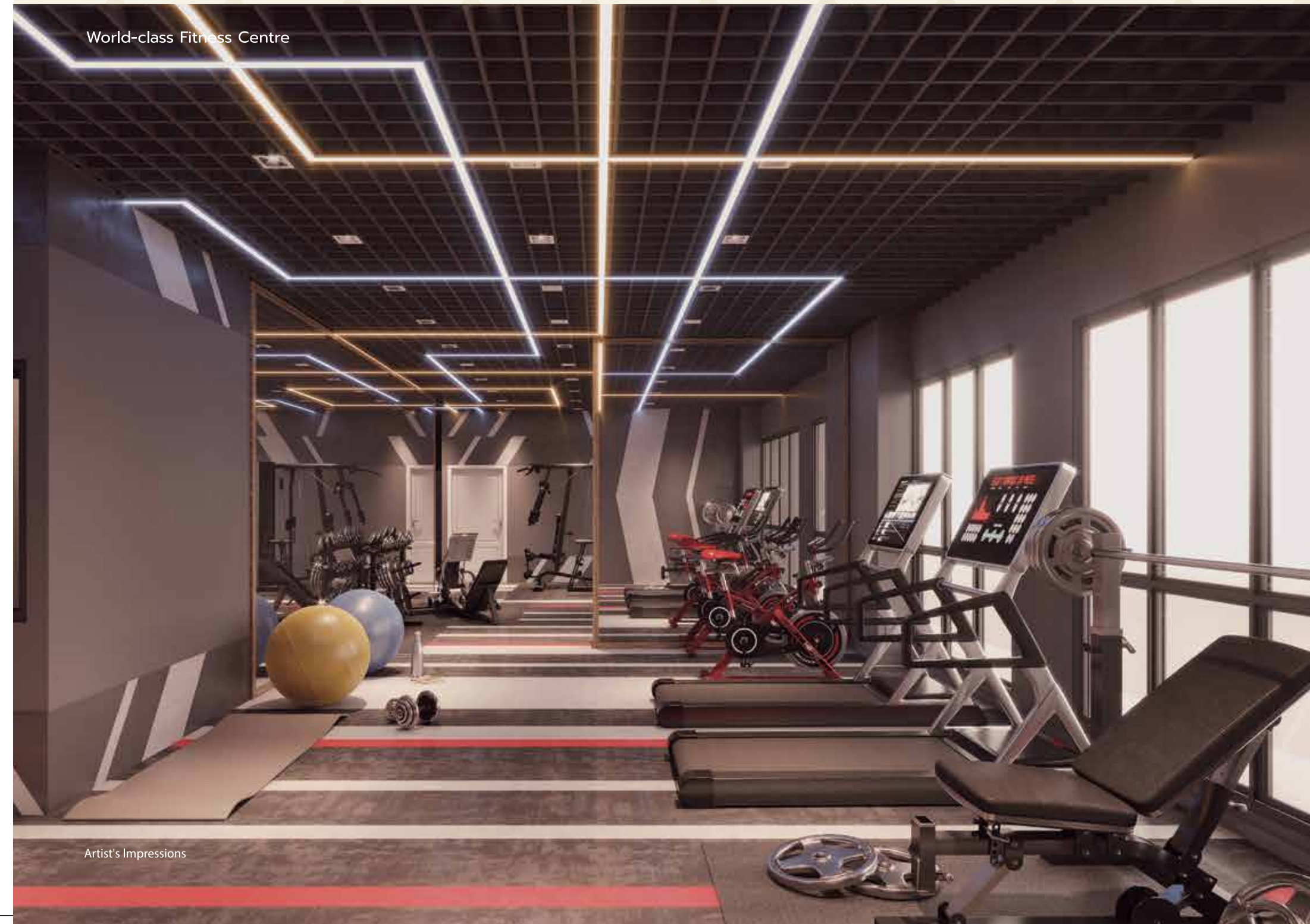

Artist's Impressions

Indoor Games Arena



Stock Image

Yoga Room & Aerobics Room



Stock Image

Mini-theatre with DTH System



Artist's Impressions

Open-to-sky Lounges and Viewing Deck

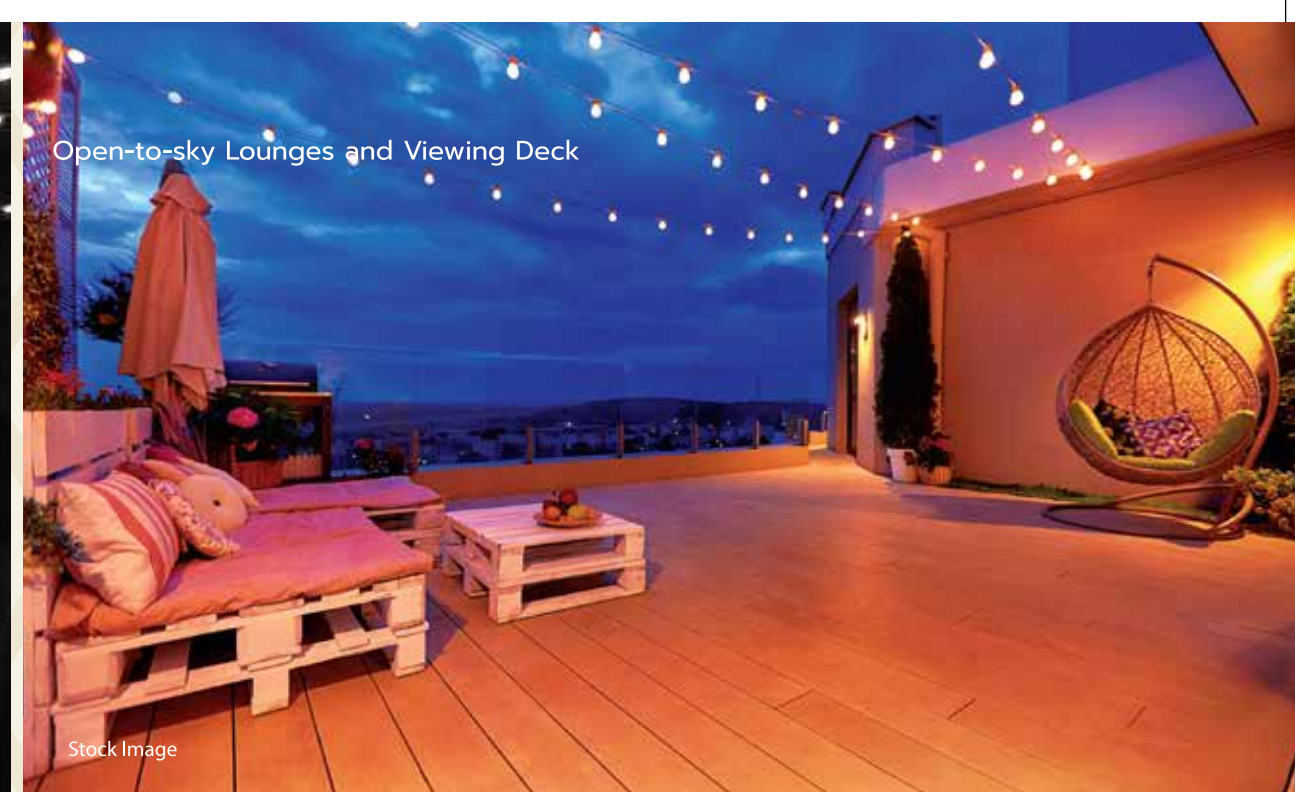

Stock Image

Elegant Banquet Hall for Celebrations



Stock Image



EXPERIENCE THE
NEXT LEVEL LEISURE,
ENTERTAINMENT AND CELEBRATIONS

ENTERTAINMENT AND CELEBRATIONS

- Mini-theatre with DTH System
- Open-to-sky Lounges and Viewing Deck
- Elegant Banquet Hall for Celebrations



A NEXT LEVEL DESTINATION OF COMFORTS & CONVENIENCES

Exclusive Tower Conveniences

- Concierge desk • High-end vitrified flooring
- Earthquake-resistant structures • Vaastu compliant residences
- Premium fitments and finishes in the washrooms
- Full-height glass facade window for an uninterrupted view
- Ample parking spaces • Security, including a lift card, CCTV, Security Personnel



Well-appointed Business Centre

Stock Image

Grand Entrance Lobby



Artist's Impressions

 **RUPAREL**
REALTY
LIVE ICONIC



Artist's Impressions



UNLEASH THE NEXT LEVEL
LANDMARK WITH
HIGH-STREET RETAIL AVENUES

WELL-DEFINED SPACES FOR RETAIL AND
LIFESTYLE OUTLETS IN PREMISES



SPACIOUS 2 BED RESIDENCES



Artist's Impressions

RUPAREL SKY GREENS - KANDIVALI (W)
MahaRERA No. P51800012513



RUPAREL PRIMERO - CHEMBUR
MahaRERA No. P51800021096



RUPAREL PANACHE - SANTACRUZ (W)
MahaRERA No. P51800046597



RUPAREL IRIS - MATUNGA (W)
MahaRERA No. P51900005988



RUPAREL ARIANA - PAREL
MahaRERA No. P51900003250



RUPAREL REGALIA - SION
MahaRERA No. P51900009359



RUPAREL SEA PALACE - NERUL
MahaRERA No. P51700005875



RUPAREL PALACIO - KANDIVALI (W)
MahaRERA No. P51800013881



RUPAREL MILLENNIA - PAREL
MahaRERA No. P51900031698



LANDMARKS OF ICONIC LIFESTYLE

DELIVERED
~2.0 MILLION SQ. FT.

UNDER CONSTRUCTION
~4.1 MILLION SQ. FT.

HAPPINESS DELIVERED TO
~2700 FAMILIES



RUPAREL ICON (JEWEL) - PAREL
MahaRERA No. P51900003058



RUPAREL LUMINARE - DADAR (E)
MahaRERA No. P51900034393



RUPAREL OPTIMA - KANDIVALI (W)
MahaRERA No. P51800013701



RUPAREL LIVIA - KURLA
MahaRERA No. P51800026450



RUPAREL WEST SKY - KANDIVALI (W)
MahaRERA No. P51800007630



RUPAREL ZION - SION CIRCLE
MahaRERA No. P51900014944



RUPAREL ORION - CHEMBUR
MahaRERA No. P51800004525



RUPAREL PRIDE - KURLA
MahaRERA No. P51800020602



RUPAREL NOVA - PAREL
MahaRERA No. P51900019946

All Images are Artist's Impression



RUPAREL
REALTY
LIVE ICONIC