



RISHABRAJ

MANGALESH

SHIMPOLI, BORIVALI WEST

The Perfect Residential Haven...

Welcome to RISHABRAJ MANGALESH a Visionary Residential Project Designed to Redefine Luxury Living. Our Premium Residential Project that Combines Luxurious Living with a Central Location and Seamless Connectivity in the Heart of Borivali West. The 12-Storey Building is Architecturally Designed to Blend Seamlessly with the Surroundings, Creating an Appealing and Harmonious Atmosphere. Indulge in an Array of World-Class Facilities, Including Unmatched Rooftop Amenities.

Life at RISHABRAJ MANGALESH Offers Premium 2 and 3-Bedroom Residences with Ample Car Parking. Visit Us to Experience the Haven.



Discover Exceptional Amenities

External Facilities



Terrace Garden



Gymnasium Space

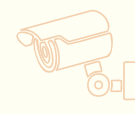

CCTV Surveillance



Kids Play Area



Yoga & Meditation Area



Walking Track



Fire Fighting System



Seating Area

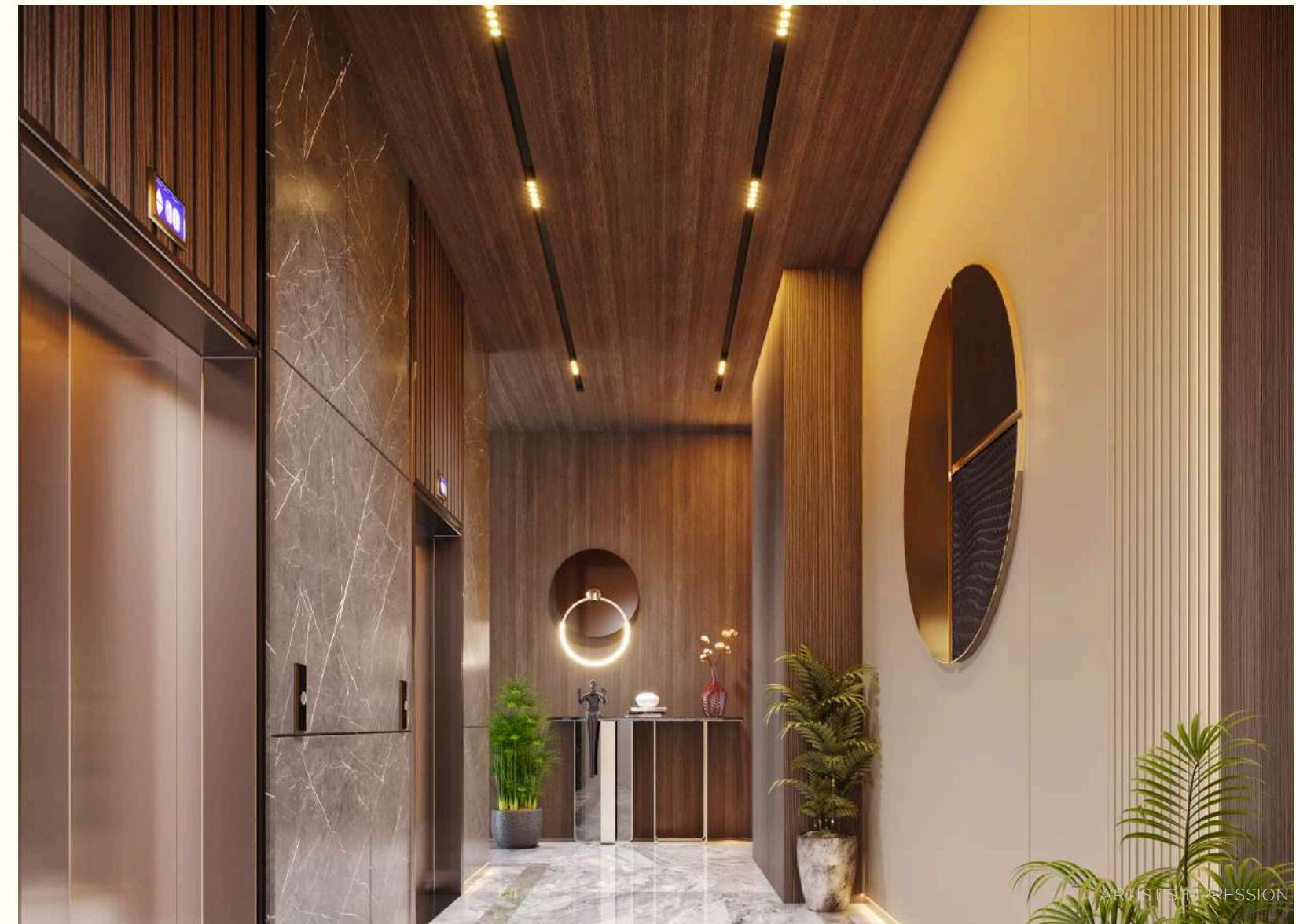

Discover Extraordinary Comfort

Internal Facilities



Intercom Connectivity

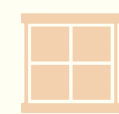

Aluminium Sliding Windows

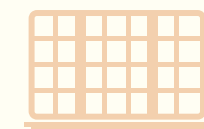

Safety Grills on External Windows



Bathroom with Anti Skid Ceramic Tile Flooring



Branded Fittings



Vitrified Flooring



Goldmedal Switches

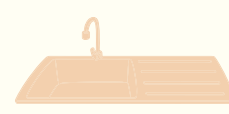

Stainless Steel Sink

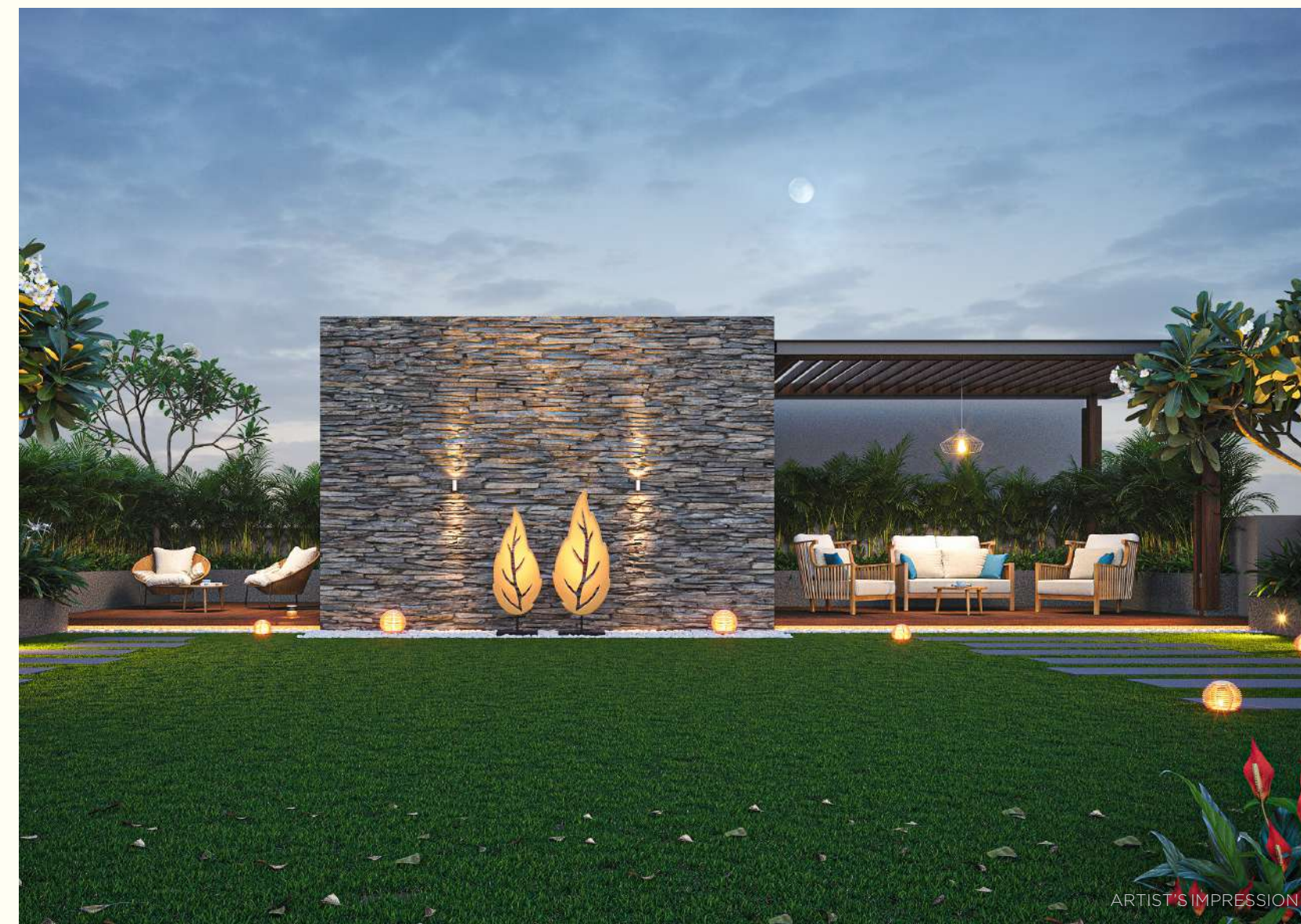

Seamlessly Connected To Your World

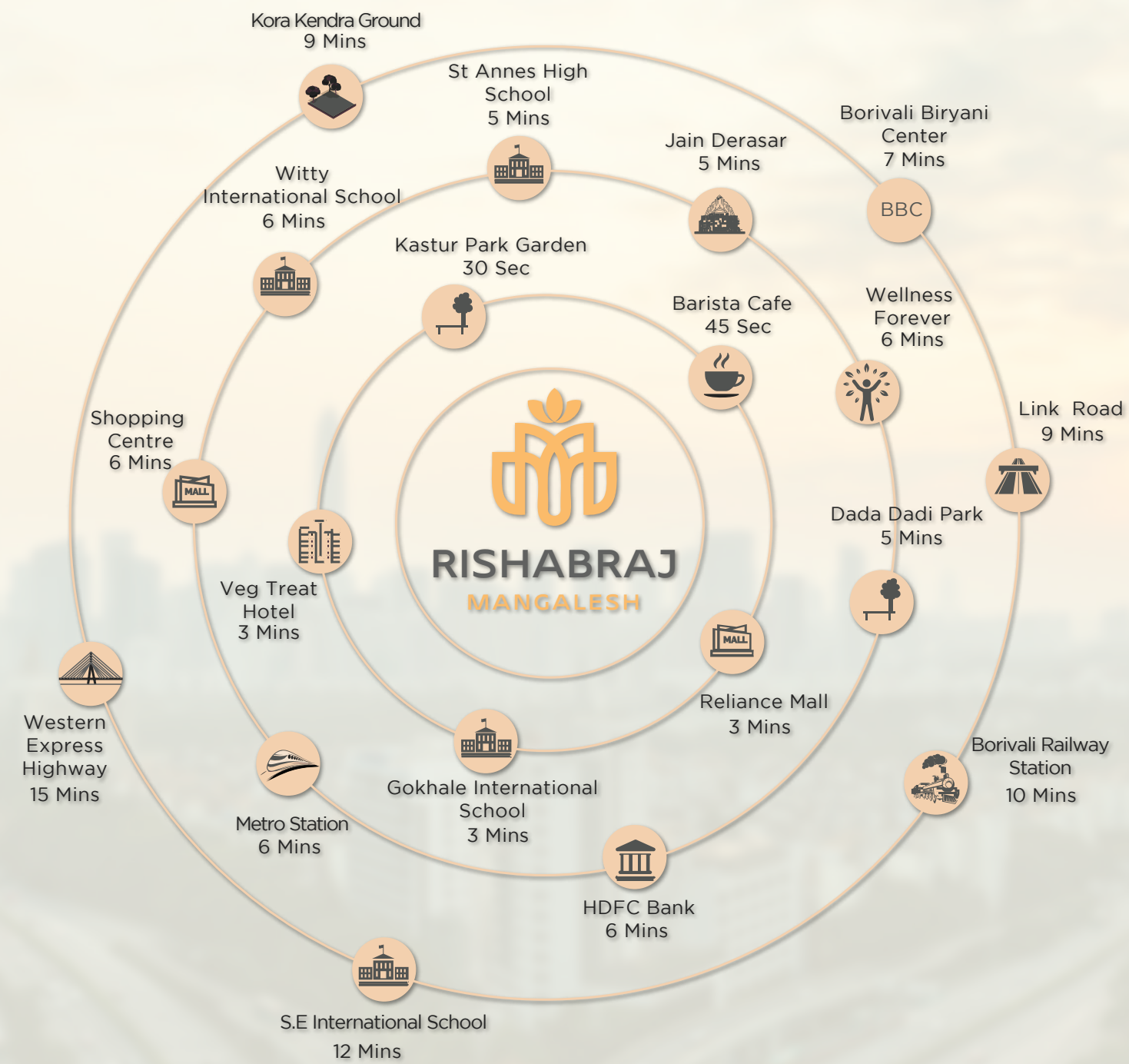

Every Brick Matters

18.30mt - WIDE EXISTING ROAD



TYPICAL FLOOR
(8TH TO 11TH FLOOR PLAN)

| FLAT NO. | TYPE | RERA CARPET AREA |
|----------|-------|------------------|
| 1 | 2 BHK | 650 SQ. FT. |
| 2 | 2 BHK | 648 SQ. FT. |
| 3 | 3 BHK | 921 SQ. FT. |

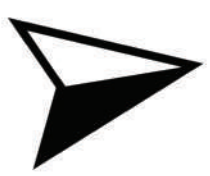

Every Brick Matters



18.30mt - WIDE EXISTING ROAD

12TH FLOOR PLAN

| FLAT NO. | TYPE | RERA CARPET AREA |
|----------|-------|------------------|
| 1 | 2 BHK | 681 SQ. FT. |
| 2 | 2 BHK | 679 SQ. FT. |

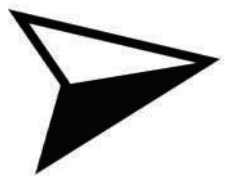

Rishabraj Classic - Malad East
MahaRera No : P51800027149



Rishabraj Villa Stella - Borivali West
MahaRera No : P51800034973



Rishabraj Vatsal - Kandivali West
MahaRera No : P51800034973



Rishabraj Vicinia - Ghatkopar East
MahaRera No : P51800026330



Rishabraj Agnel - Borivali West
MahaRera No : P51800033878



Rishabraj Ashish - Borivali West
MahaRera No : P51800007607



Blue Lotus - Santacruz West
MahaRera No : P51800033826



Rishabraj Rameshwar Darshan - Borivali West
MahaRera No : P51800030723



Rishabraj Sujai - Malad East
MahaRera No : P51800031075



PIONEERS IN REDEVELOPMENT

45+
Projects

20,00,000+
Square Feet of Ongoing
& Completed Projects

3,000 +
Happy Families

Rishabraj Phoenix - Borivali West
MahaRera No : P51800033878



Rishabraj Pride - Dahisar West
MahaRera No : P51800031144



Rishabraj Park Vitas - Borivali West
MahaRera No : P51800032136



52 Park Avenue - Khar west
MahaRera No : P51800032136



Samaj Darshan - Kandivali west
MahaRera No : P51800010749



Rishabraj Matruchhaya - Borivali East
MahaRera No : P51800034195



63 GMA - Goregaon West
MahaRera No : P51800027330



Rishabraj Gardenia - Jogeshwari East
MahaRera No : P51800035106



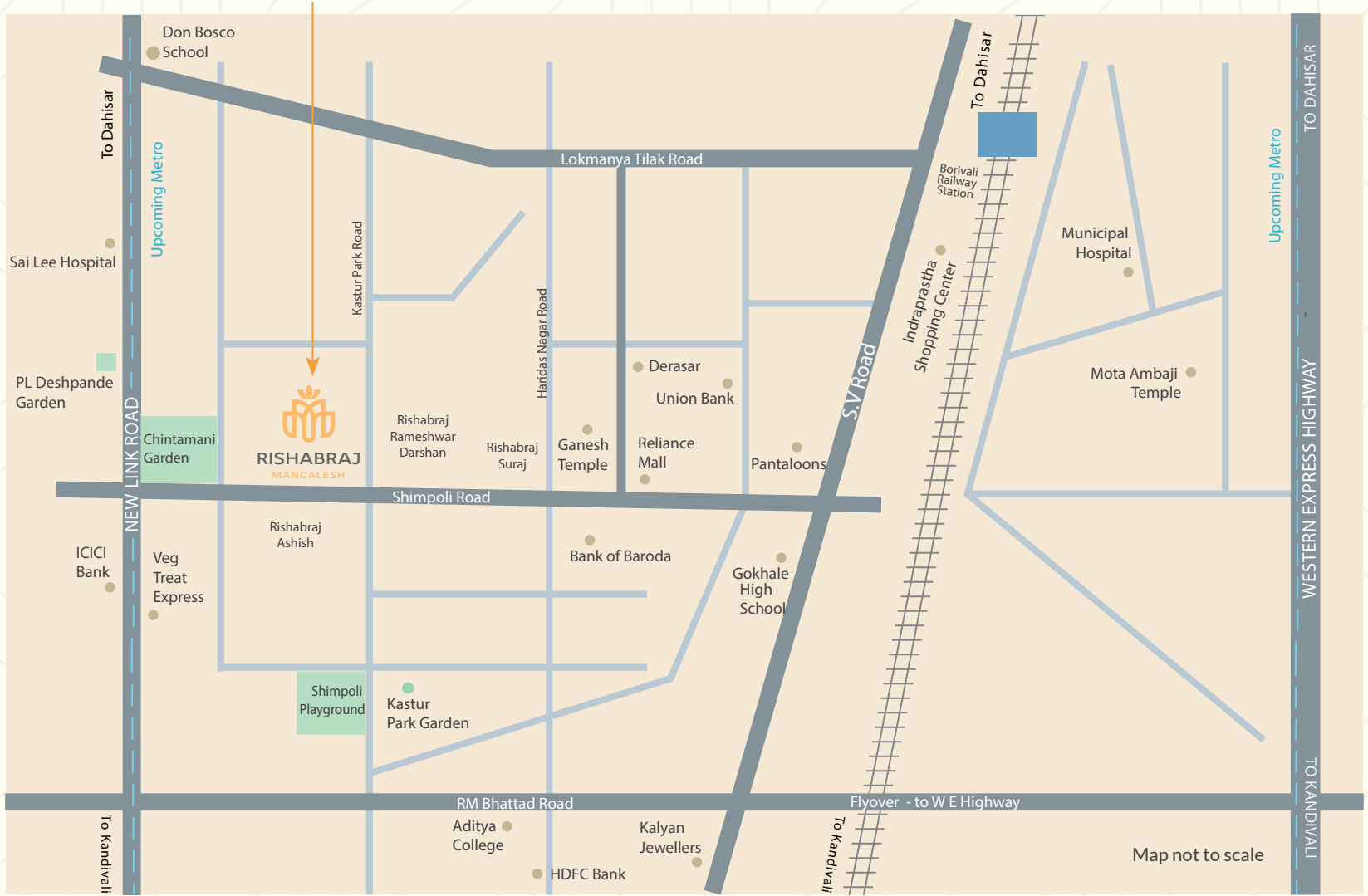

H. RISHABRAJ

Site Address : Plot bearing F.P No. 275A of TPS Borivali no. III. Eksar Village, Shimpoli Road at Borivali (West) Mumbai - 400092.

Get In Touch: 8989 72 4545 | 8989 73 4545 E : sales@hrishabraj.com W : www.hrishabraj.com

MahaRERA No : P51800050841 <https://maharera.mahaonline.gov.in>

Disclaimer: The specifications, images and other details herein are only indicative and the Promoter reserves the right to change any or all these in the interest of the development. This printed material does not constitute an offer and/or contract of any type between the promoter and the recipient. Any purchase/lease of this development shall be governed by the terms and conditions of the agreement for sale entered into between the parties and no details mentioned in this printed material shall in anyway govern such a transaction.

GET IN TOUCH

