



PCPL™
ANKUR
RESIDENCY

Experience LIFE IN FULL BLOOM



Ankur Residency By PCPL™

Welcome to PCPL Ankur Residency, a place where modern conveniences harmoniously meld with the comforts of modern living. Ankur Residency, which is in the centre of Mumbai's thriving Malad (West) area, provides a perfect fusion of urban living and leisure. A suitable location for families looking for a convenient way of life is PCPL Ankur Residency. Our neighbourhood, which offers a wide range of amenities for people of all ages, is sure to satisfy all members of your family, young and old alike. The banks, educational facilities, recreational facilities, hospitals, and commercial developments are all conveniently positioned close to our residential complex. Take advantage of quick proximity to important transit hubs like the recently built Metro station and S.V. Road, Link Road, and Western Express Highway. Ankur Residency provides unmatched connectivity, whether you need to travel to work, run errands, or just explore the city.

At PCPL Ankur Residency, we understand the value of spending time with loved ones. We've included a variety of conveniences to let you relax and take pleasure in some downtime because of this. Our cutting-edge gym is the ideal place to work up a sweat and reach your fitness objectives, while the sensory garden provides a tranquil setting for connecting with those you value. Our Toddler's Play Area is guaranteed to be popular with children, while our Yoga Deck and Walking Track are great for seniors.

Our apartments are designed to make advantage of as much natural light and ventilation as possible. To assure your comfort and convenience, every unit has been carefully built with contemporary conveniences and high-end finishes.

Come and live a convenient and comfortable life by choosing PCPL Ankur Residency.



PCPL™: The Visionary Journey Towards Excellence in Real Estate Development

Pranav Constructions Private Limited (PCPL) embarked on its journey in 2003 with a small but visionary step. From its humble beginnings of handling individual projects, PCPL has rapidly grown into a reputable company, capable of managing multiple large-scale projects concurrently, all while maintaining an unwavering commitment to quality and timely delivery.

Headquartered in Mumbai, where time is an invaluable commodity, PCPL has already completed and has ongoing projects, encompassing an impressive 1.25 million square feet, bringing joy to over 2500 delighted families.

Moreover, PCPL has committed to delivering an additional 1.7 million square feet of developments.

PCPL has firmly established itself as a pioneer in the realm of affordable luxury homes by delivering every project on schedule and at fair and competitive prices. This unwavering commitment to quality and customer satisfaction has earned the company the trust and loyalty of its customers.

Home that Refresh and Re-energize



Live Life in Full Bloom



Amenities to help you bloom

Toddler's Play Area

Zen Garden

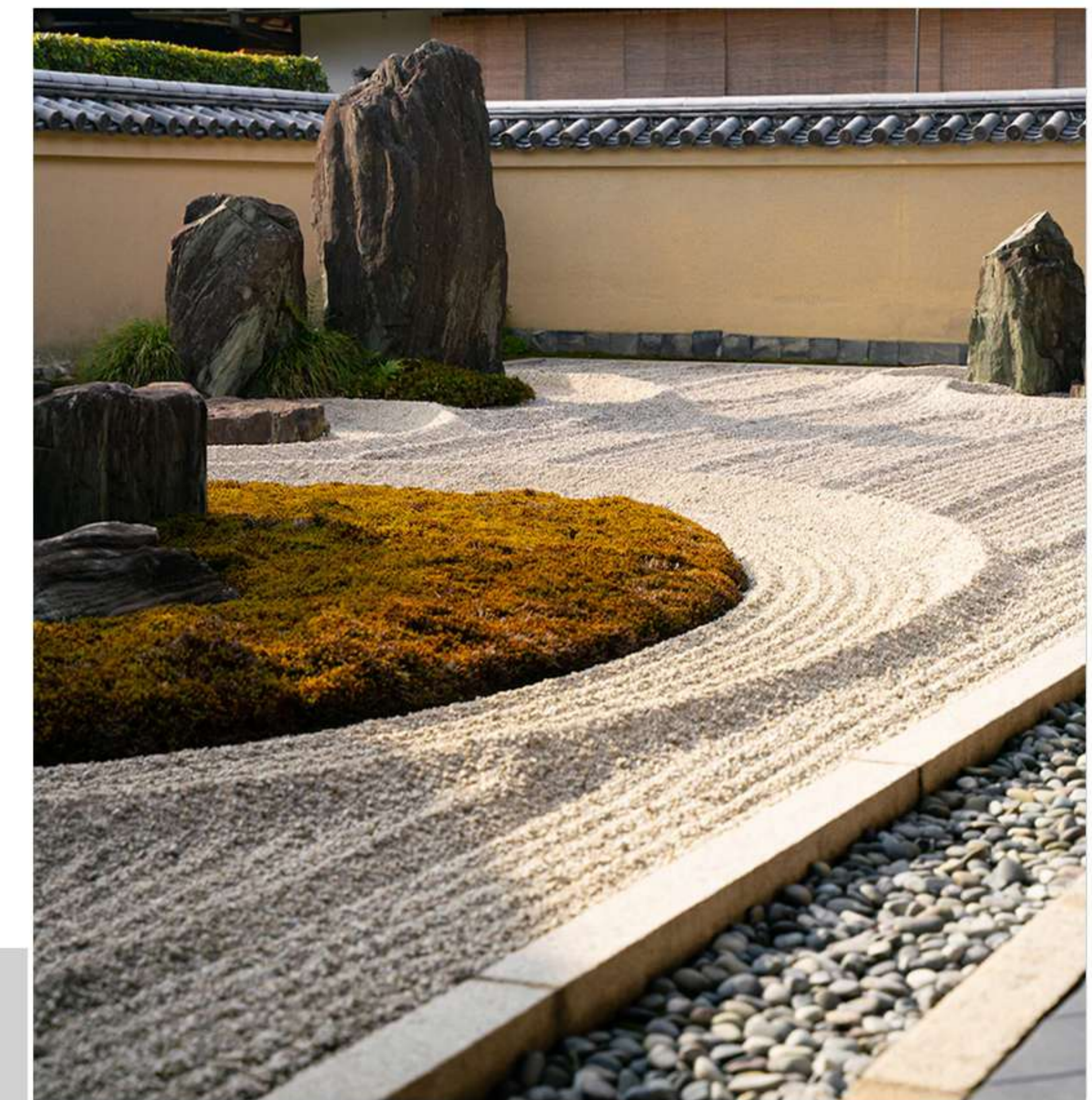
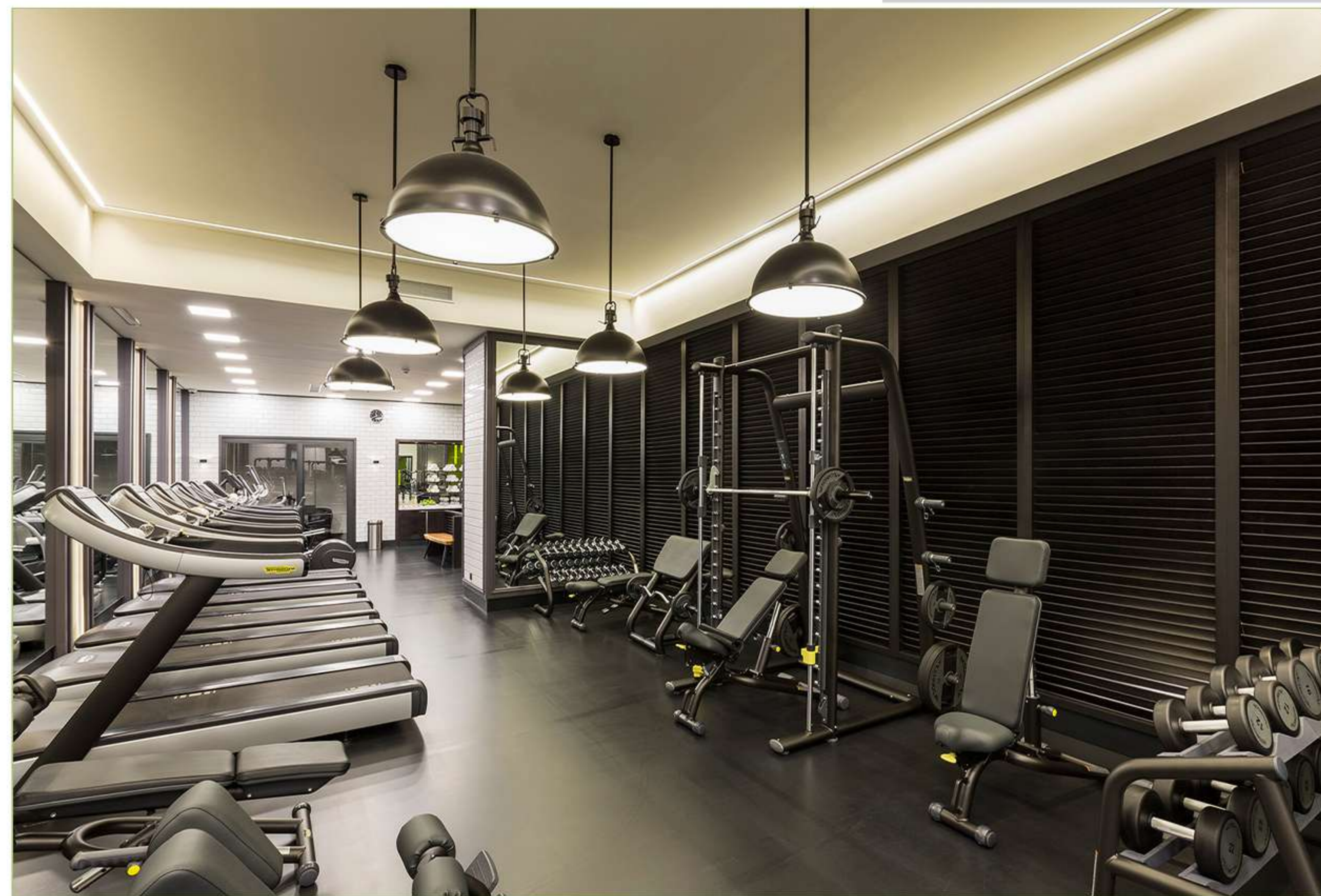

Gymnasium

Seating Area





Yoga Deck



Sensory Garden



Barbeque Area

Walking Track

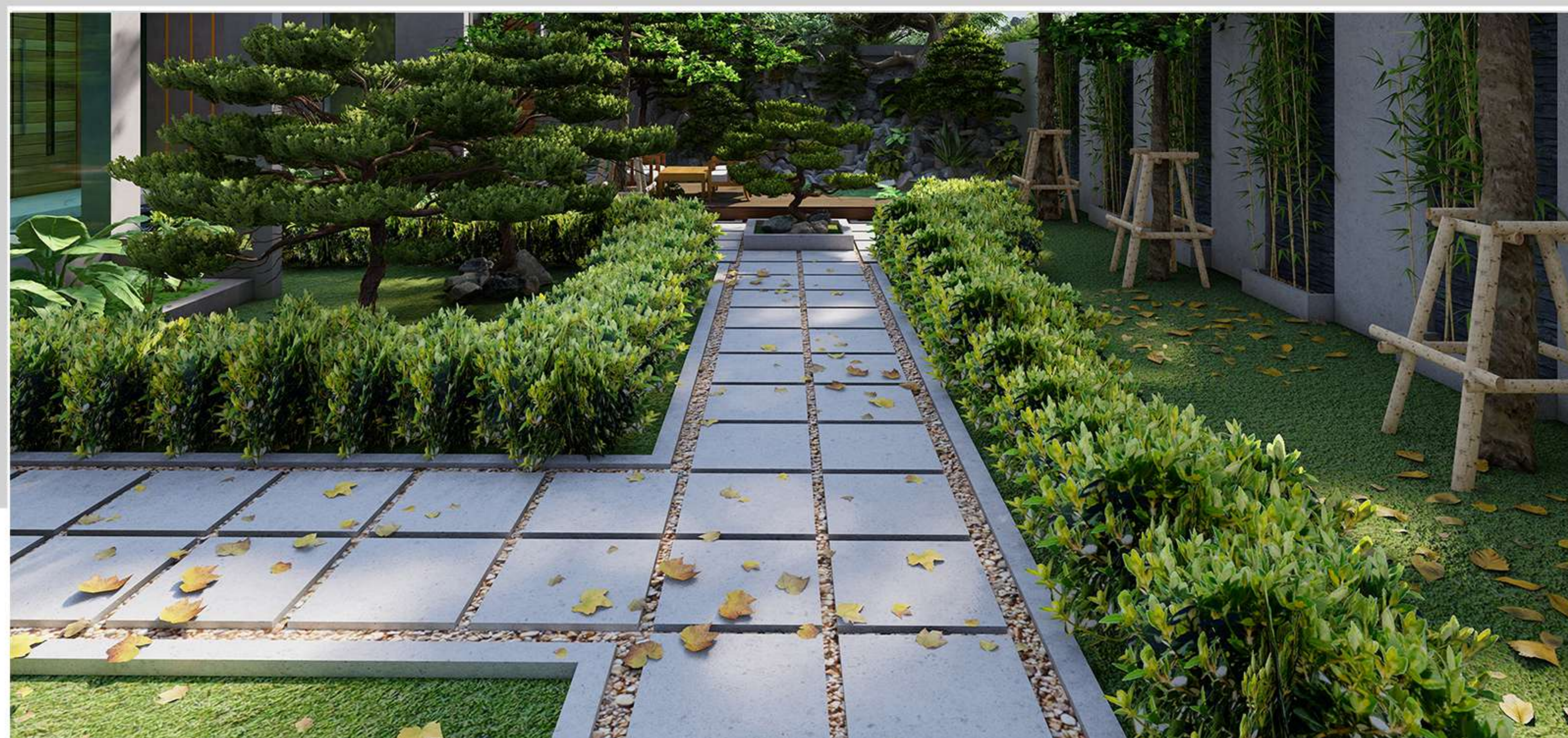



Ankur Residency Floor Plans

At Pranav Constructions Private Limited (PCPL), we're passionate about creating homes that effortlessly blend modern living with smart space utilization. Our meticulously designed homes are tailored to cater to the varied needs of our customers, ensuring that every square foot is optimized for maximum comfort and convenience.

Discover the perfect harmony of form and function at PCPL.

Flat Configuration

2 Bhk & 3 Bhk Available

2 BHK : 641 sq. ft., 664 sq. ft.

3 BHK : 841 sq.ft.



Ground Floor Plan



Terrace Floor Plan

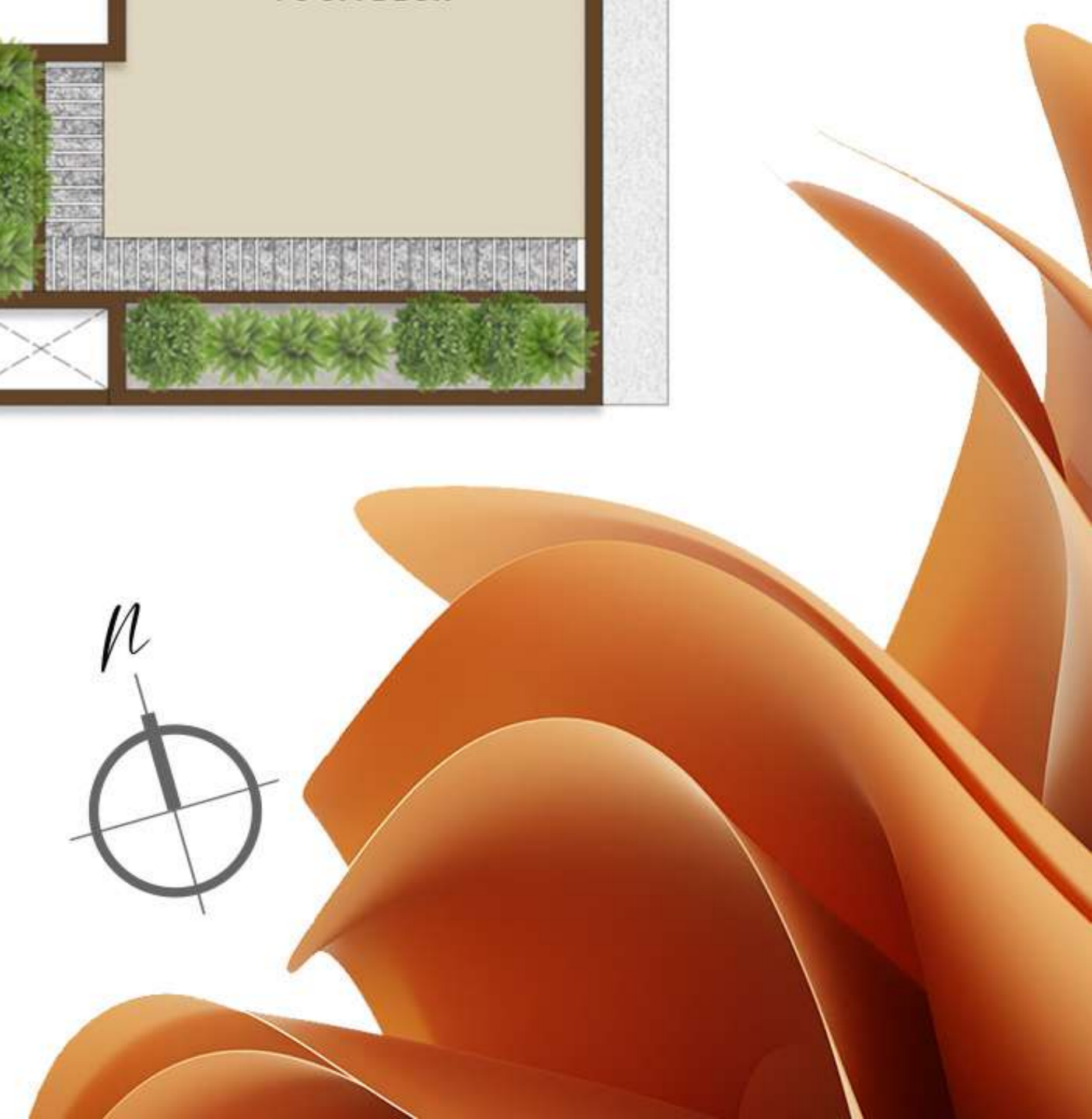

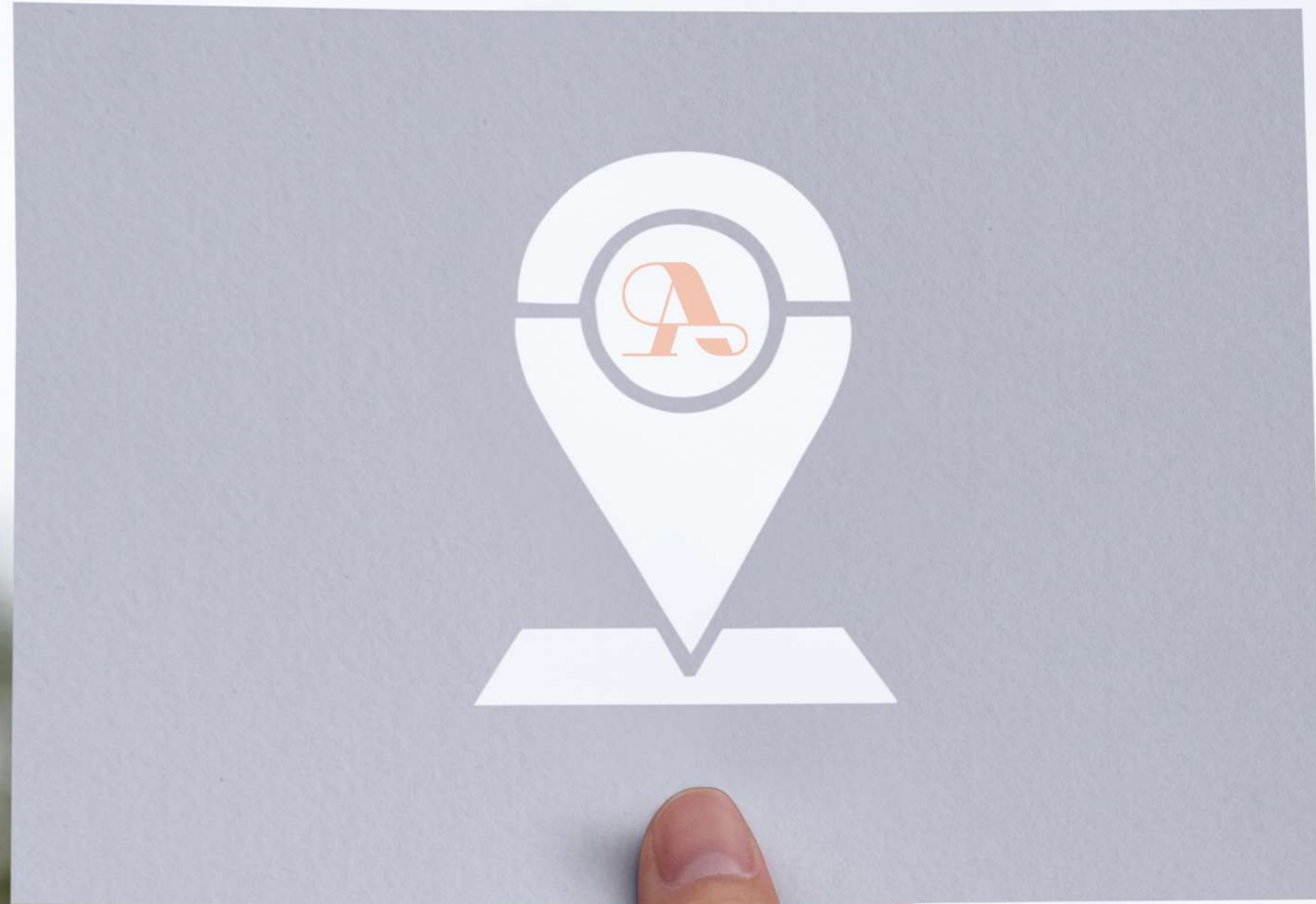

The Perfect
blend of
comfort and
connectivity.



LOCATION SALIENCE

TRANSIT

Malad Railway Station: 1.30Km

S.V. Road: 1.10Km

Western Express Highway: 4.30Km

Link Road: 0.90 Km

Malad west Metro Station: 1.00Km

Mamletdar wadi Road: 0.40 Km

COMMERCIAL DEVELOPMENTS

Lotus Corporate Park : 7.00 Km

Nesco IT park: 6.00 Km

Nirlon Knowledge Park: 6.10 Km

BKC: 20.00 Km