



For representation purpose



For representation purpose



For representation purpose

REJUVENATION IS HERE

- Grand lobby
- Rooftop podium deck
 - Landscaped Garden
 - Party Lawn
 - Jogging Track
 - Kid's Play Area
 - Sports Pitch
 - Sitting Area
- Yoga & meditation
- Indoor games room
- Gym
- Library
- Sauna and spa
- Mini theatre
- Virtual game zone
- Cafeteria



Artist's Impression



Artist's Impression



Artist's Impression



Artist's Impression



Artist's Impression



Artist's Impression



Artist's Impression

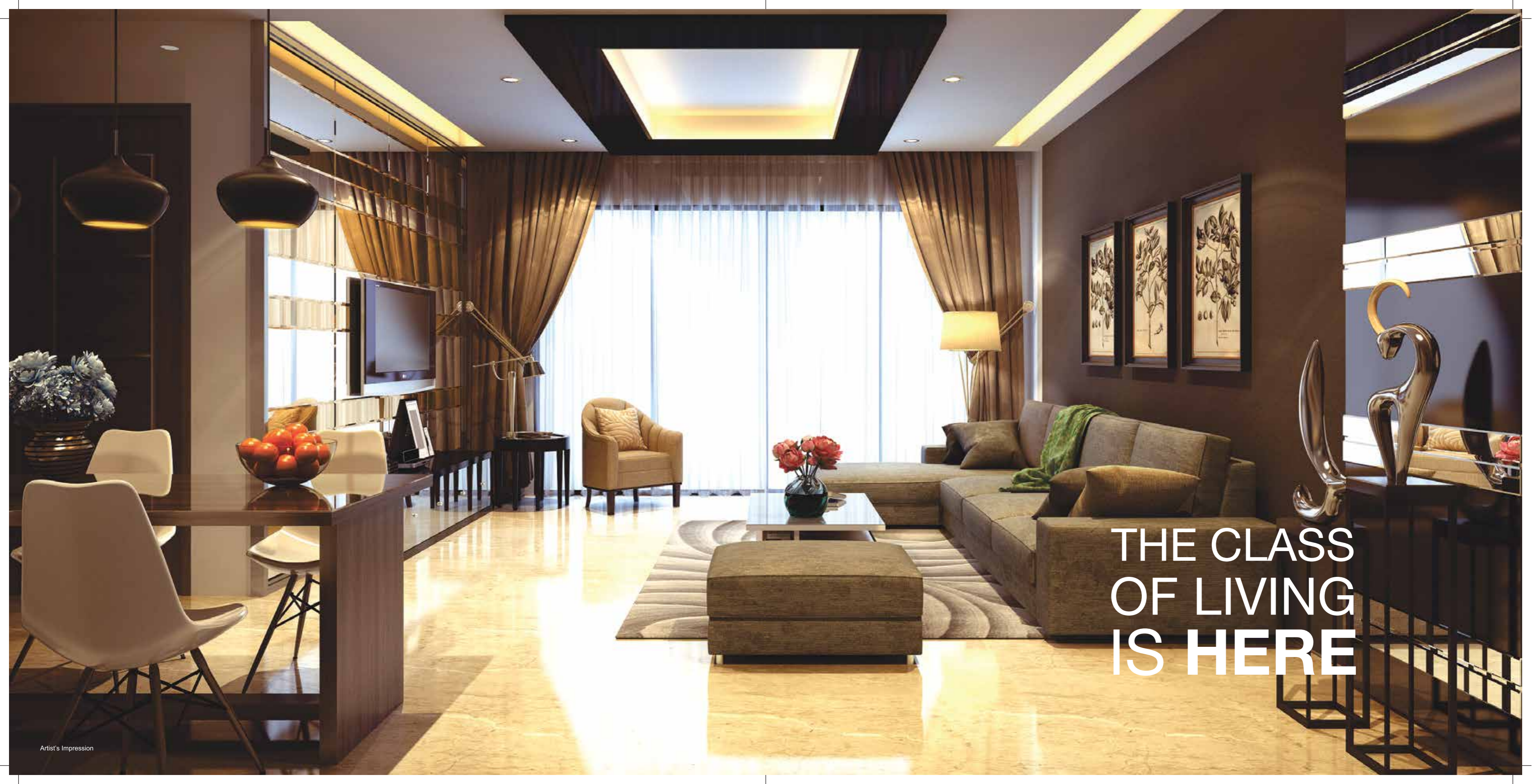

THE CLASS
OF LIVING
IS HERE

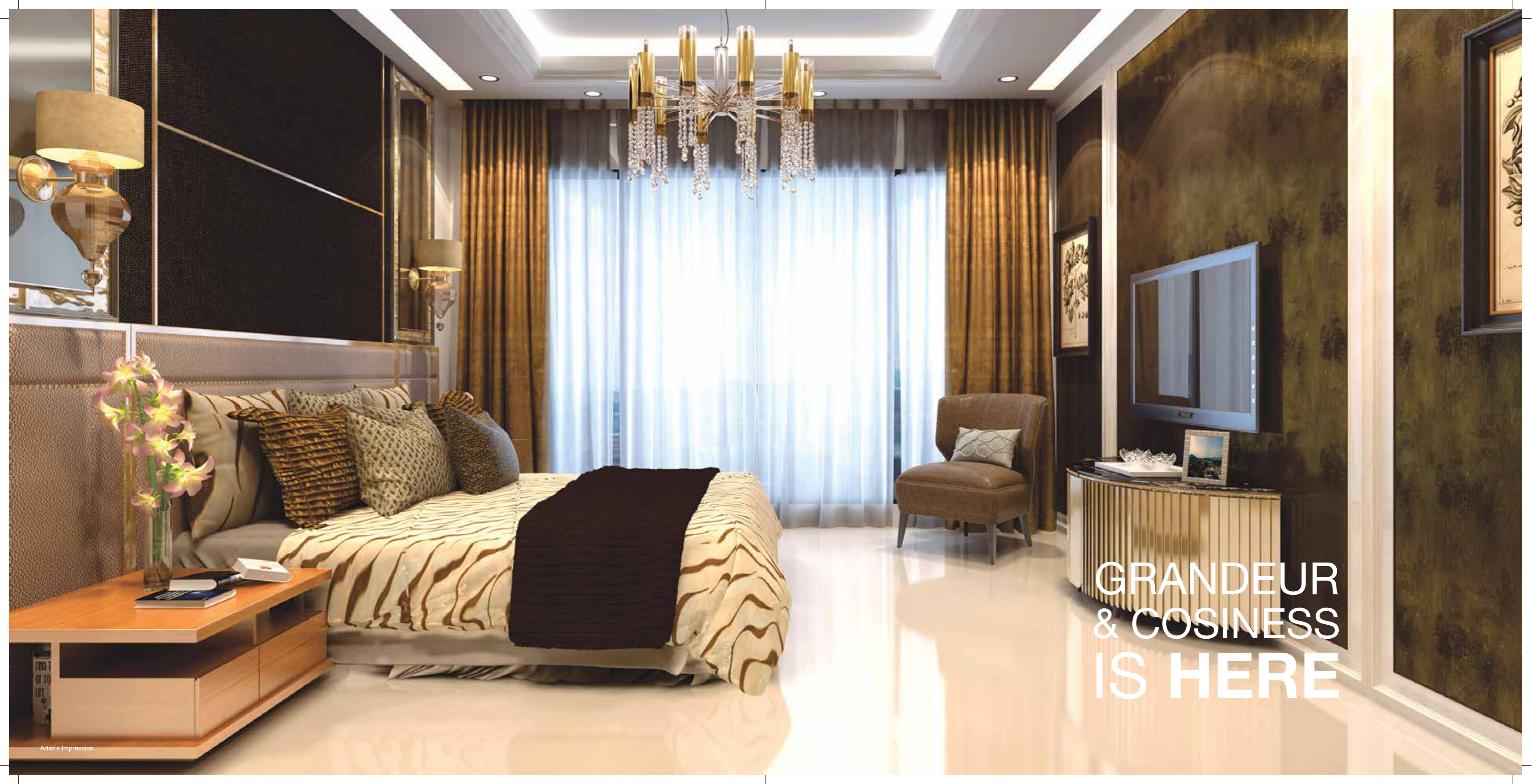

GRANDEUR
& COSINESS
IS HERE



Artist's Impression

FINENESS IS HERE

- Vitrified flooring for living room, dining room, kitchen and all bedrooms
- Vitrified tiles for bathroom flooring
- Wash-basin counters
- Vitrified tiles dado full height for height for bathrooms
- Vitrified tiles dado 2' high above kitchen platform
- Kitchen platform with stainless steel sink with drain board
- Laminated internal flush doors
- Quality electrical switches
- Video-door phone
- Branded C.P. fittings
- Split AC/VRV*
- Modular kitchen*
- Wardrobe*

*on chargeable basis and as per terms & conditions specified by the developer.

MASTER LAYOUT



TYPICAL FLOOR PLAN

35th to 40th, 42nd to 46th

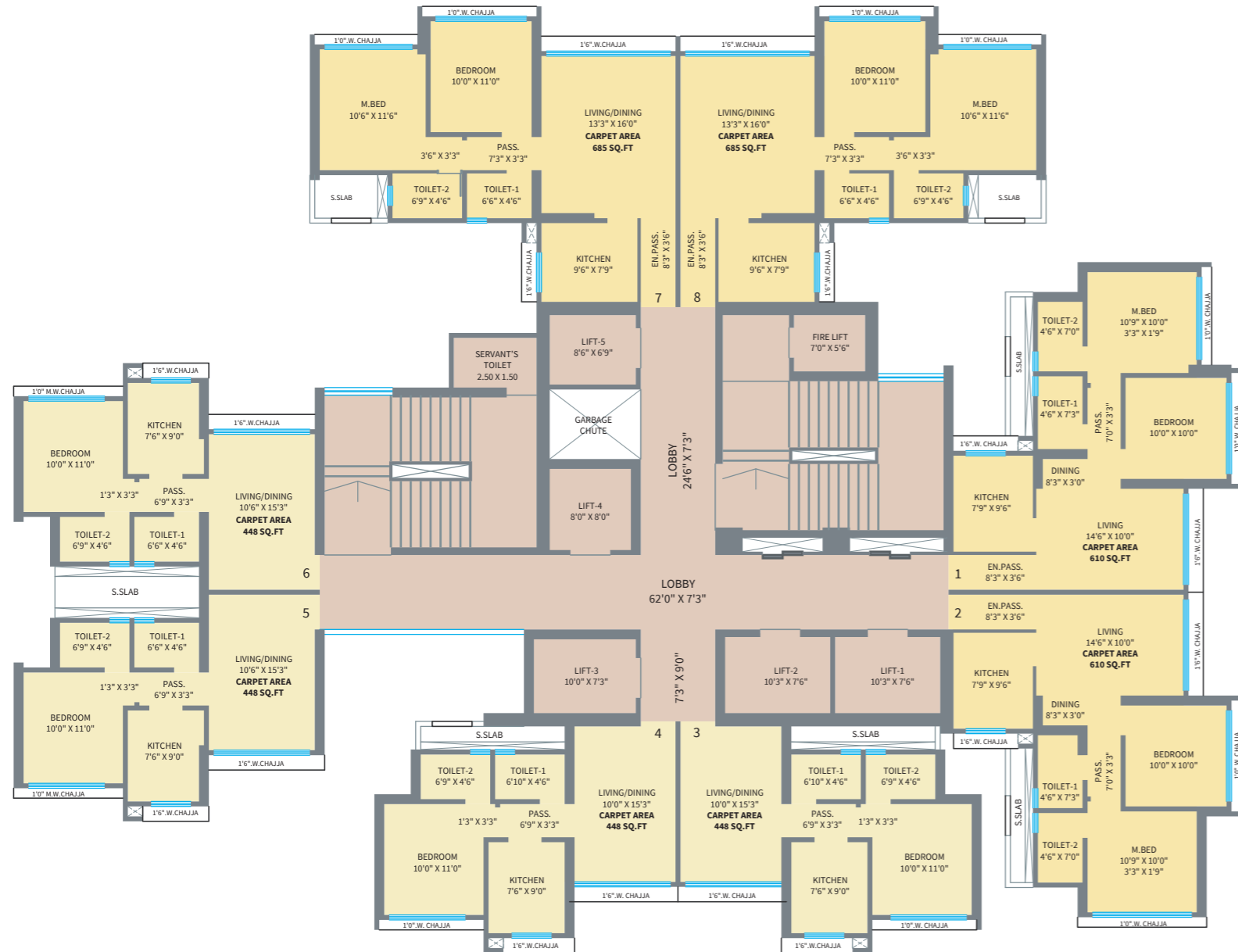

1BHK UNIT PLAN

CARPET AREA = 448.00 SQ.FT.

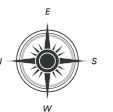
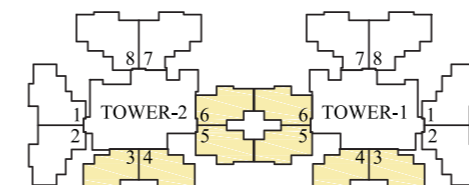
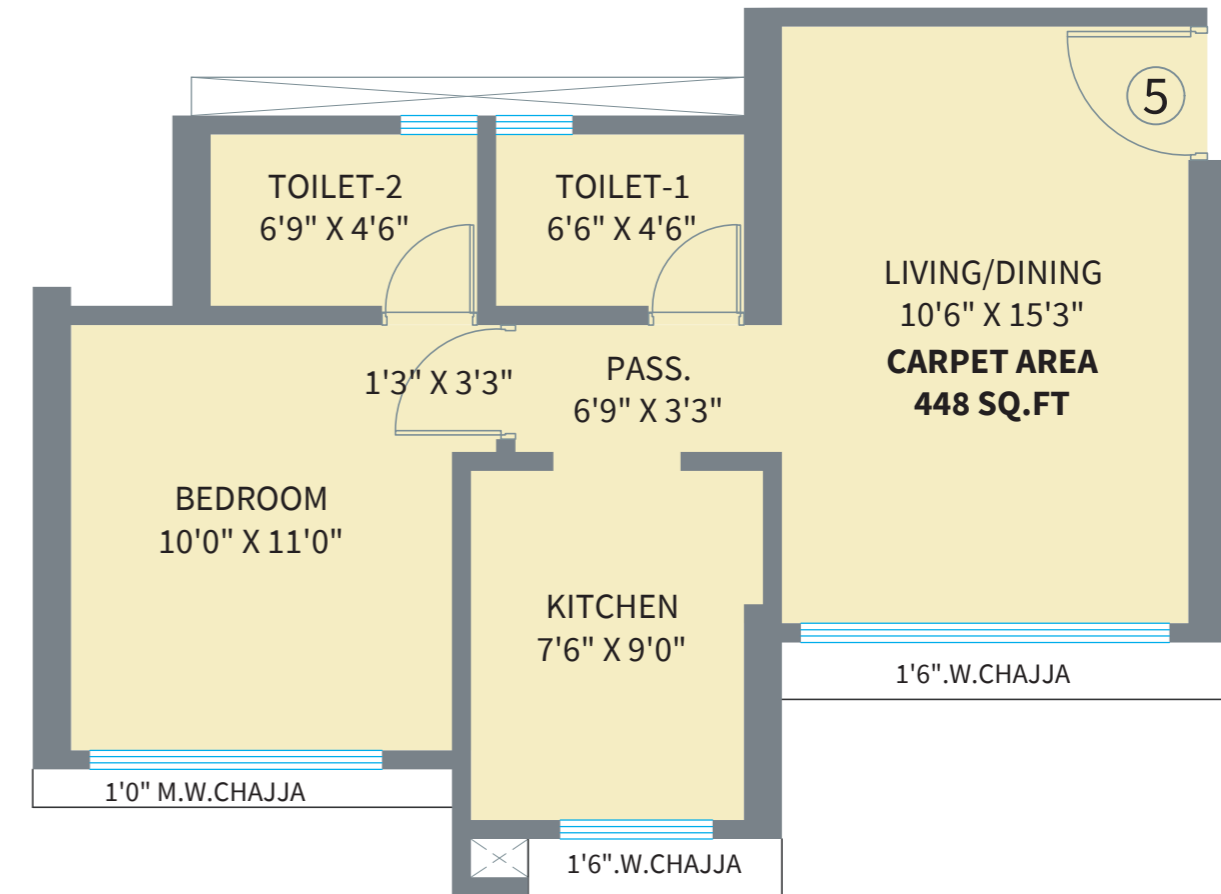

2BHK UNIT PLAN

CARPET AREA = 610.00 SQ.FT.

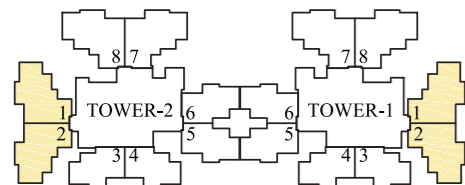
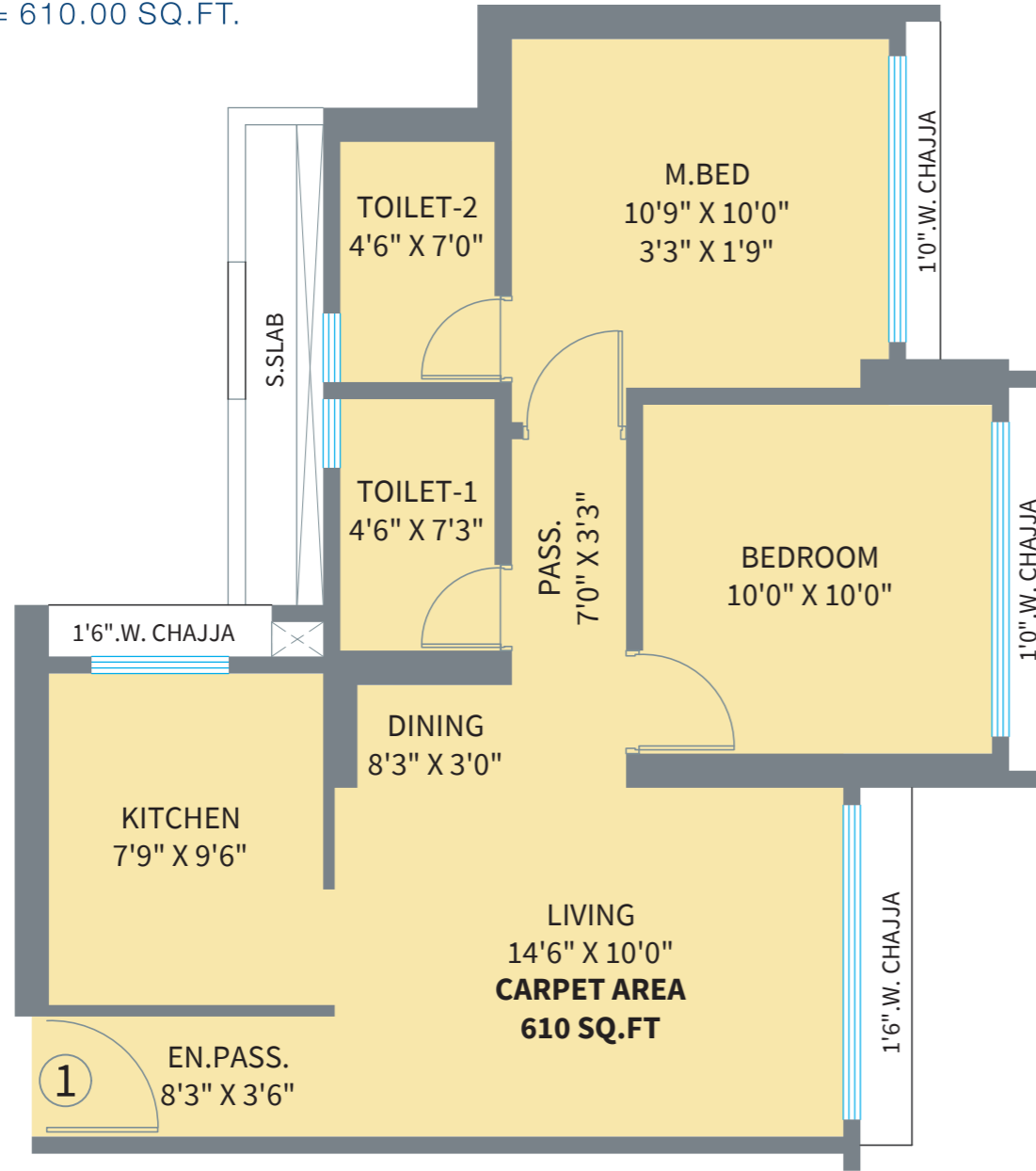

2BHK UNIT PLAN

CARPET AREA = 685.00 SQ.FT.

