

### ESSENTIAL

- EXTENSIVE ELECTRICAL LAYOUT
- CABLE & TELEPHONE POINTS
- GRANITE KITCHEN PLATFORM • GAS PIPELINE
- VITRIFIED FLOORING
- CONCEALED WIRING

### LUXURY INTERNAL

- QUALITY SANITARY WARE • QUALITY C.P FITTINGS
- HOT WATER GEYSER IN MASTER BEDROOM
- HEAVY SECTION ANODIZED POWDER COATED SLIDING WINDOW
- GRANITE SILLS ON WINDOW FRAMES
- INTERCOM • AUXILIARY PLATFORM • GLAZED DADO TITLES
- CONCEALED PLUMBING WITH GOOD QUALITY FIXTURES

### LUXURY EXTERNAL

- GRAND ENTRANCE LOBBY
- MASSIVE MAIN GATE
- CCTV SURVILLIANCE
- 24/7 SECURITY
- STRATEGIC SECURITY CABIN
- SYSTEMATIC SOCIETY OFFICE
- JOGGING/WALKING SPACE
- SIT OUT AREAS
- MODERN GYMNASIUM
- SHOWER STALLS
- LIBRARY
- BOARD GAMES ZONE
- CARROM ZONE
- TABLE TENNIS ZONE
- SENIOR CITIZEN SITTING AREA
- FUN KIDS PLAY ACTIVITIES

### ULTRA LUXURY EXTERNAL

- STEAM ROOM
- JACUZZI
- STUDY ZONE
- TEMPLE
- REFLEXOLOGY PATH
- MEDITATION DECK
- MULTI PURPOSE COURT
- CRECHE
- GUEST ROOM/ ISOLATION CENTER
- BANQUET HALL
- BUSINESS CENTER
- CHILDREN'S POOL
- TERRACE PARTY AREA
- SPORTS PITCH
- HANGOUT GAZEBOS

### INTERNAL

- INTERNET FIBRE LINE
- PLATFORM CABINET
- POWER BACK UP FOR COMMON AREAS
- FIRE SPRINKLERS
- VISITOR VIDEO APP INSTALLATION
- SEWAGE TREATMENT PLANT
- RAINWATER HARVESTING
- AGM AGENCY INSTALLATION

## A M E N I T I E S

ANGELOI  
(KIDS ZONE)

CASA CLUB  
(CLUBHOUSE)

ESPIRITUAL  
(SPIRITUAL ZONE)

BON JOUR  
(HOSPITALITY AREA)

FEISTA  
(HANGOUT/CHILL OUT)

### LOCATION MAP WITH MUMBAI METRO ROUTE

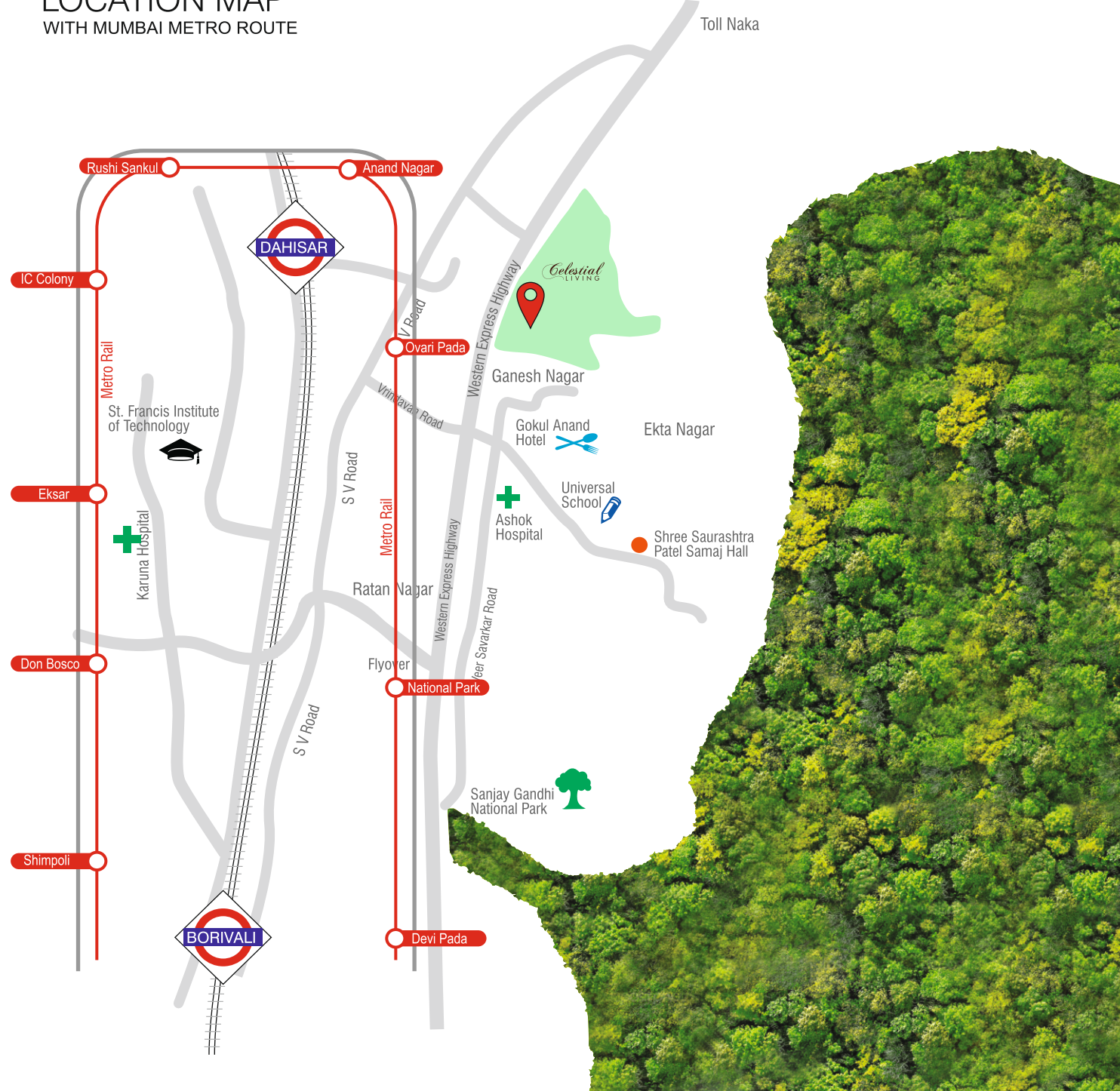

### Location Advantage

- Close to Sanjay Gandhi National Park
- Located near Western Express Highway
- 5 Mins walk from Dahisar Railway Station
- 10 Mins walk from Borivali Railway Station
- Hospitals & Clinics located within the radius of 2.3Kms
- Renowned Schools & Colleges are sited diagonally to Oyster Living

### Project Address -

Oyster Living, DHPL, Rawalpada,  
Near Gokul Anand Hotel,  
Western Express Highway,  
Dahisar East, Mumbai - 68.

OYSTER LIVING DHPL  
www.celestialliving.in

Member  
CREDIT-MCHH

Office Address: Oyster Living  
306, 3rd Floor, Western Edge - 1, Western Express  
Highway, Borivali East, Mumbai - 66.  
Tel: + 91 9833936766.  
Email: sales@celestialliving.in • Website : www.celestialliving.in

Disclaimer: The information, layout, pictures etc. shown in this proposal are subject to approval from all concerned authorities. The builder / developer shall have unconditional right to change, alter etc. the said plans, drawings, information.

Celestial Living

Bano Forever  
**Mumbaikar**  
Bano  
**Limitless**

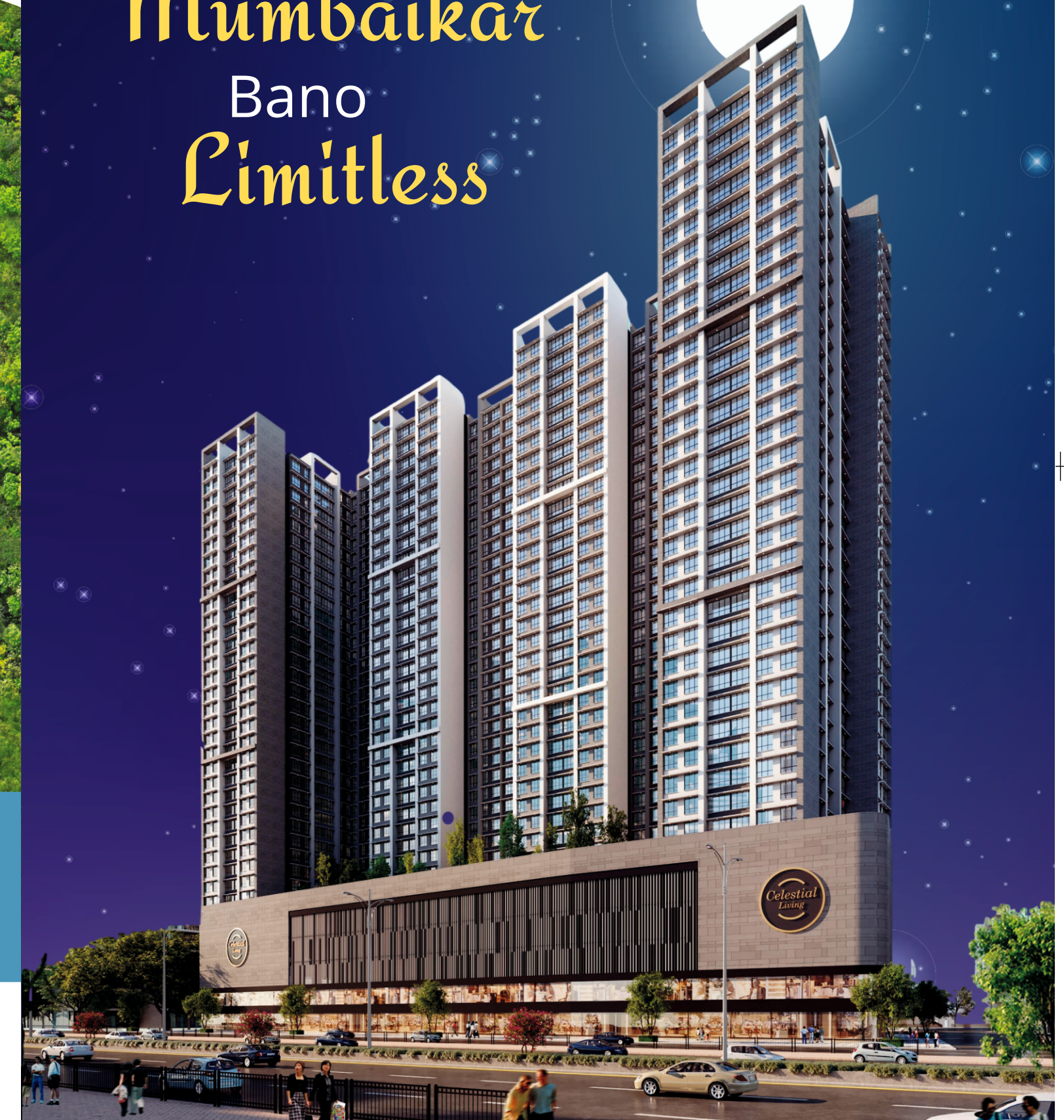

MahaRera No: P51800028969

www.CelestialLiving.in

1  
Divino

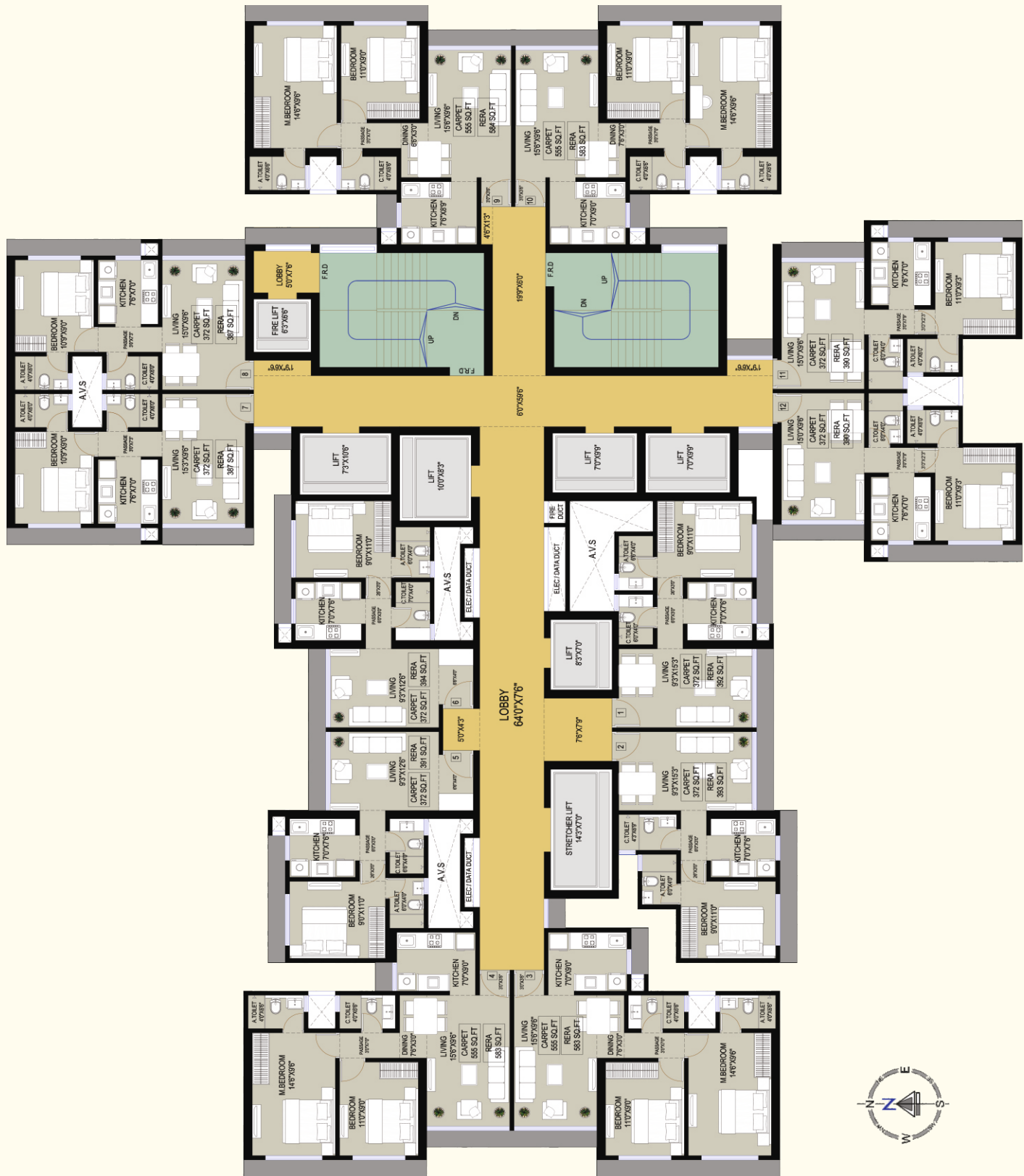

2&3  
Elixir

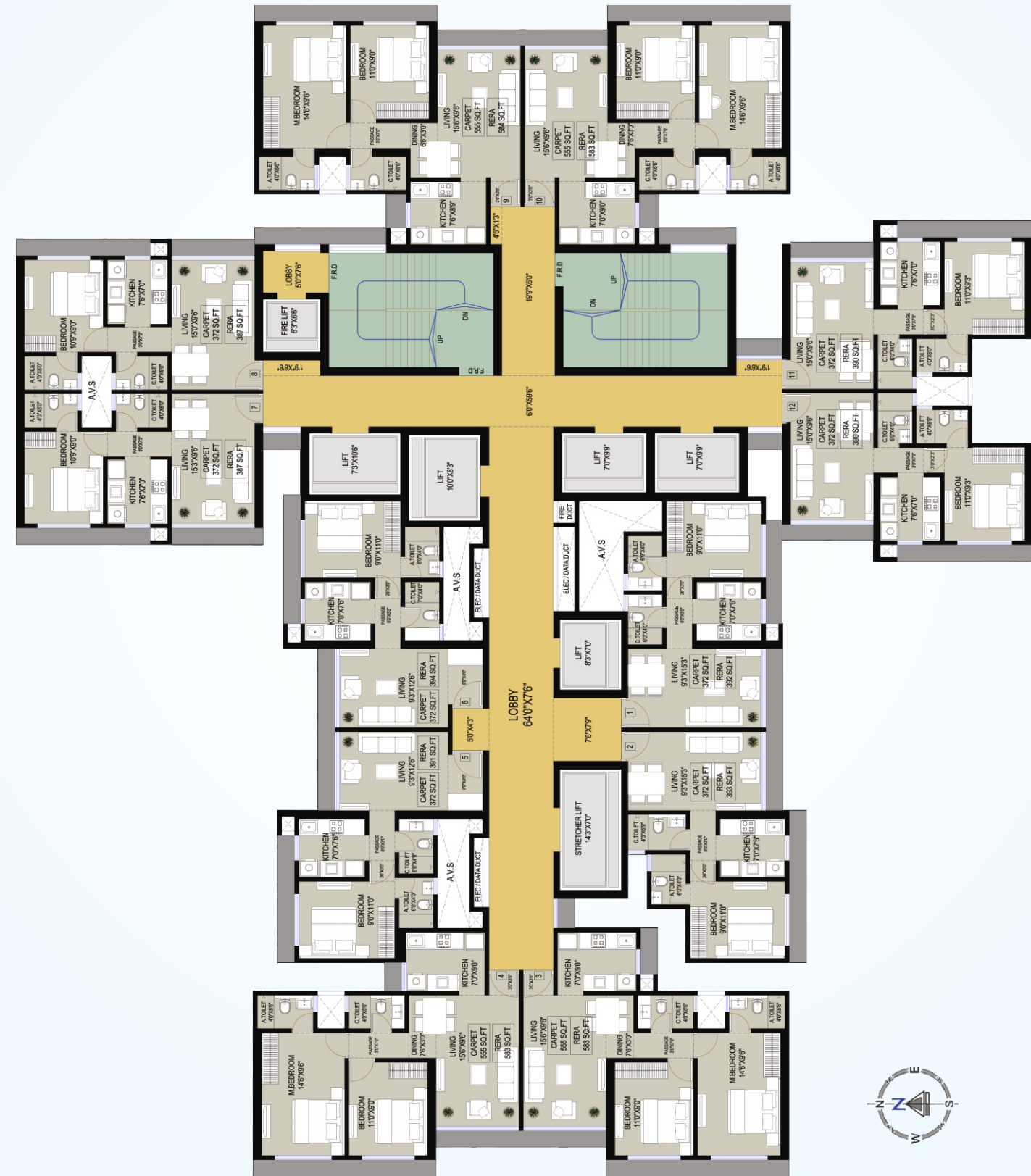

4  
Aura

