

www.veenasynergy.com

A Project By:



VEENA DEVELOPERS

*Your Dreams... Are Our Homes...*

# VEENA Synergy

FEEL THE RHYTHM OF LIFE

**ANDHERI EAST**



ARTISTIC IMPRESSION

**2 & 3 BHK  
PREMIUM HOMES**

A woman with long brown hair, wearing a vibrant red turtleneck top and a matching red blazer, is seated on a black chair. She is looking directly at the camera with a neutral expression. The background consists of dark wood-paneled walls. To her right, a decorative plant with large, fan-shaped, golden-brown leaves is placed on a dark, reflective surface. The overall lighting is warm and focused on the woman.

**WHERE IS THE FINEST  
PREMIUM HOMES IN MUMBAI ?**

**WHAT'S THE PERFECT  
CONNECT FOR EVERYDAY ?**

**HOW ARE THE ELEMENTS OF  
BETTER LIVING CRAFTED ?**

If you have all these questions, we have all the  
answers with an iconic life like no other in Andheri (E).



# ANDHERI'S NEWEST ICON, YOUR ADDRESS OF PRIDE.

Your imagination of supreme luxury living, finest indulgences, perfect connect and finely curated experiences will now all come true at Andheri's newest lifestyle landmark. Open your world to bliss that stays with you for a lifetime. A perfect address that is perfected to suit you.

- Spacious 1, 2 & 3 Bed Residences
- Seamless Ventilation
- Grand Entrance Lobby
- Home Automation with Alexa\*
- Ground Floor, Rooftop & Podium Amenities
- Electric Vehicle Charging Facility
- 24x7 Security & Surveillance System



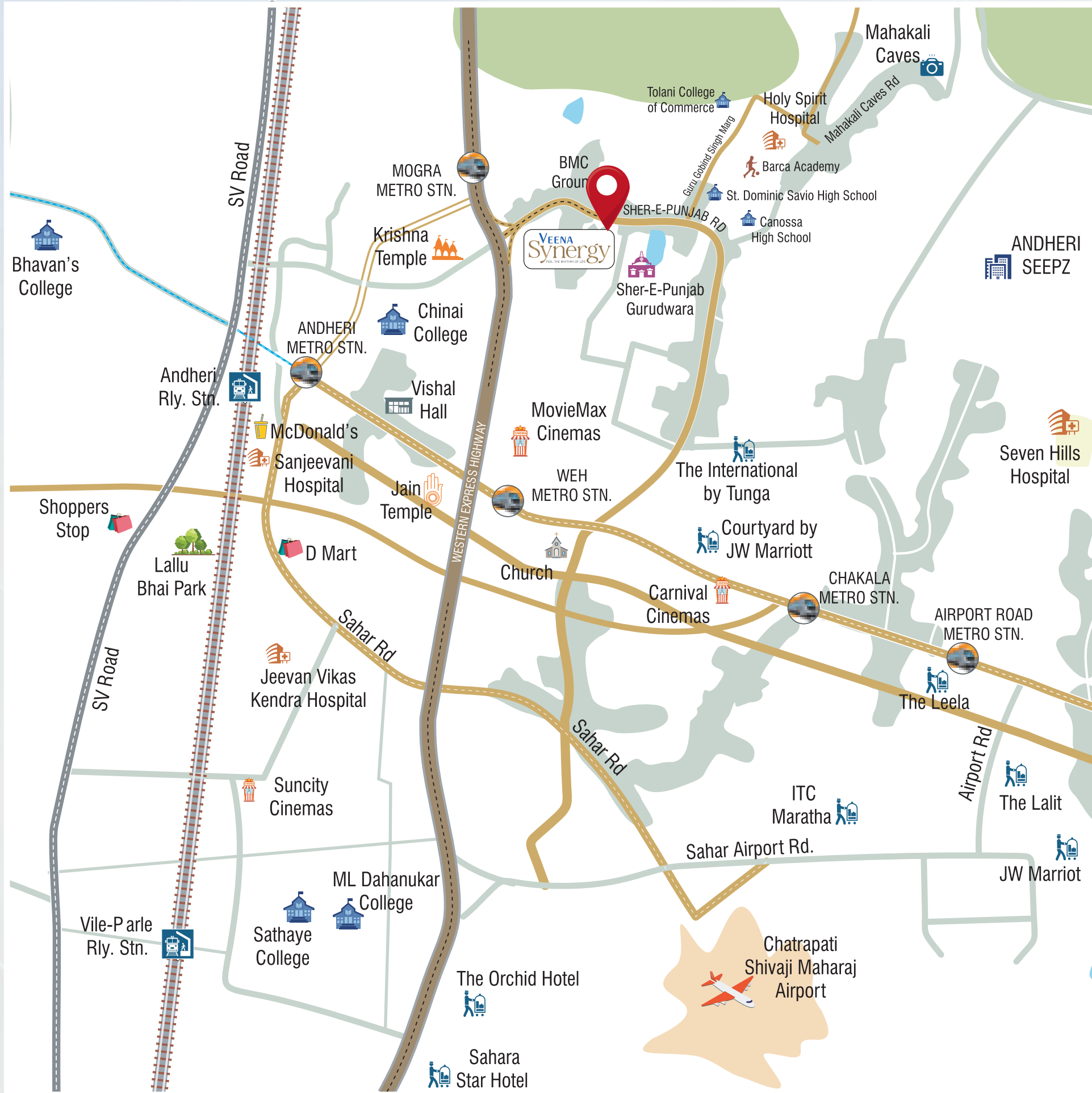

## ANDHERI EAST - THE CENTER OF YOUR WORLD.

In a city like Mumbai, staying connected is the biggest luxury you'll ever have. But, we've already taken care of that with an address so prime, the entire world converges to offer you a comfortable and convenient life. Your home, your work, your weekend treats and your peace of mind - It's all connected and at your disposal.

- 
**CONNECTIVITY**  
 W.E.H. - 3 Min  
 Metro Station - 4 Min  
 Andheri Station - 10 Min
- 
**AIRPORTS**  
 Domestic Airport - 15 Min  
 International Airport - 15 Min
- 
**FINANCE**  
 Axis Bank - 2 Min  
 Federal Bank - 2 Min  
 State Bank of India - 3 Min  
 HDFC Bank - 5 Min
- 
**EDUCATION**  
 Tolani College of Commerce - 3 Min  
 Swami Vivekanand High School - 5 Min  
 Oberoi International School - 12 Min
- 
**HOSPITALS**  
 Shakuntala Hospital - 3 Min  
 Holy Spirit Hospital - 4 Min  
 Seven Hills Hospital - 15 Min
- 
**ENTERTAINMENT**  
 Carnival Cinemas - 10 Min  
 Movie Time - 12 Min
- 
**RELIGIOUS**  
 Sher-E Punjab Gurudwara - 1 Min  
 Hanuman Mandir - 1 Min  
 Sacred Heart Church - 3 Min  
 Ganesh Temple - 5 Min  
 Jain Temple - 8 Min  
 Haveli - 8 Min
- 
**BUSINESS HUB**  
 MIDC - 10 Min  
 SEEPZ - 15 Min  
 Nesco IT Park - 20 Min  
 Mind Space - 30 Min  
 BKC - 20 Min

\*Approx Time as per Google map



**THE LANDMARK OF EXCELLENCE.  
A GATEWAY TO ENDLESS POSSIBILITIES.  
AN ADDRESS THAT SETS YOU A CLASS APART.**

---

WHEN DAILY ABUNDANCE BECOMES PART OF LIFE,  
A promise of brilliant living takes its course strategically planned and designed world-class privileges at three levels, rooftop, podium, and ground level for well-defined experiences.



Artistic Impression



**ENTRANCE COURTYARD**

Artistic Impression



**GRAND ENTRANCE LOBBY**

Artistic Impression





KID'S PLAY AREA

Artistic Impression



Artistic Impression

**WELL-EQUIPPED GYM**



Artistic Impression

**PODIUM LEVEL GARDEN AND ELEVATED JUICE BAR**



**INDOOR GAMES ROOM**



Artistic Impression





ROOFTOP LEVEL BOX CRICKET

Reference Image

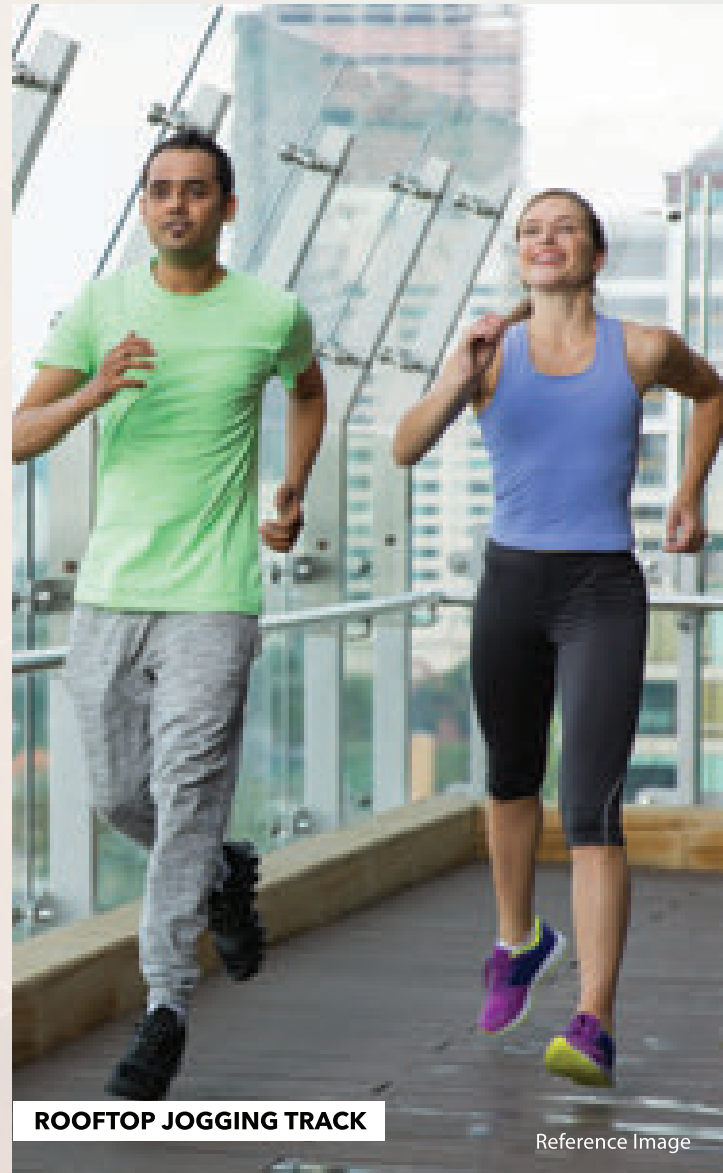

ROOFTOP JOGGING TRACK

Reference Image

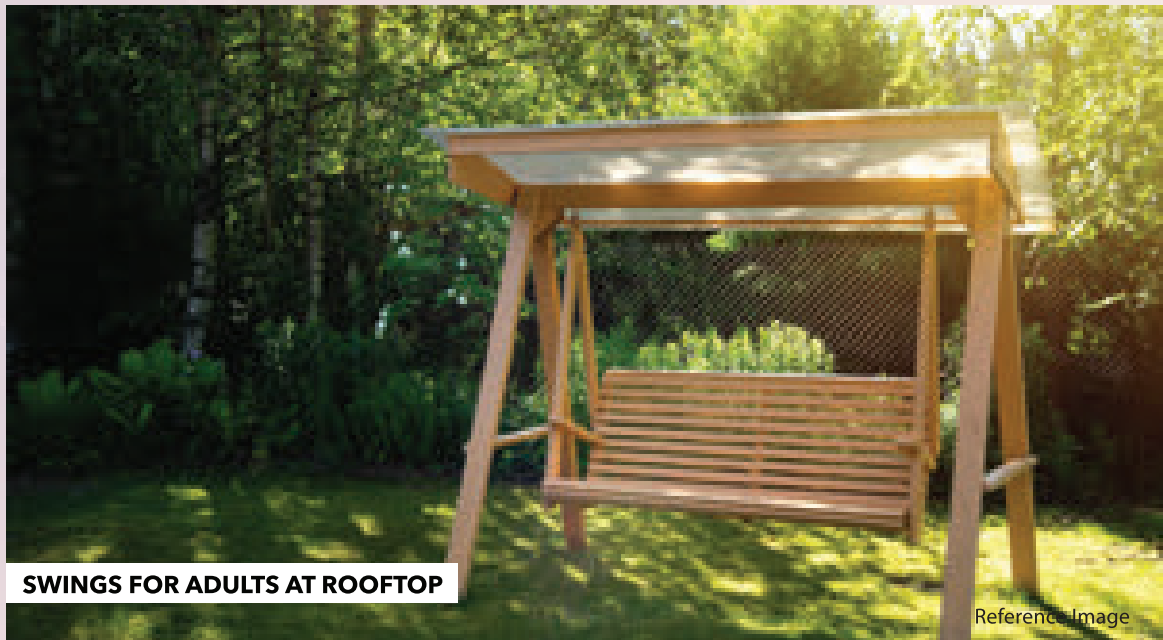

SWINGS FOR ADULTS AT ROOFTOP

Reference Image



ROOFTOP SKATING RINK

Reference Image



ROOFTOP FITNESS LAWN

Reference Image

## ELEMENTS OF BLISS THAT ADD TO YOUR HAPPINESS

### GROUND FLOOR AMENITIES

- Blissful Landscaping
- Kid's Play Area
- Toddler's Area
- Seating Corner
- Security Cabin

### PODIUM LEVEL AMENITIES

- Landscaped Garden
- Fountain
- Amphitheatre
- Modern Sculpture
- Yoga & Meditation Deck
- Senior Citizen's Sit-out
- Acupressure Pathway
- Chit-chat Corner
- Reflexology Path
- Multipurpose Lawn
- Elevated Juice Bar
- Barbeque Deck
- Open Dining & Lounge
- Swings for Adults
- Featured Wall Painting

### ROOFTOP LEVEL AMENITIES

- Seating Area
- Garden Swings
- Box Cricket Area
- Basketball Hoop
- Fitness Lawn
- Jogging Track
- Ludo Board & Hopscotch
- Skating Rink
- Place for Solar Panel
- Preparation Deck
- Lounge
- Chit-Chat Corner
- Yoga Deck

## Typical Floor Plan: Wing A

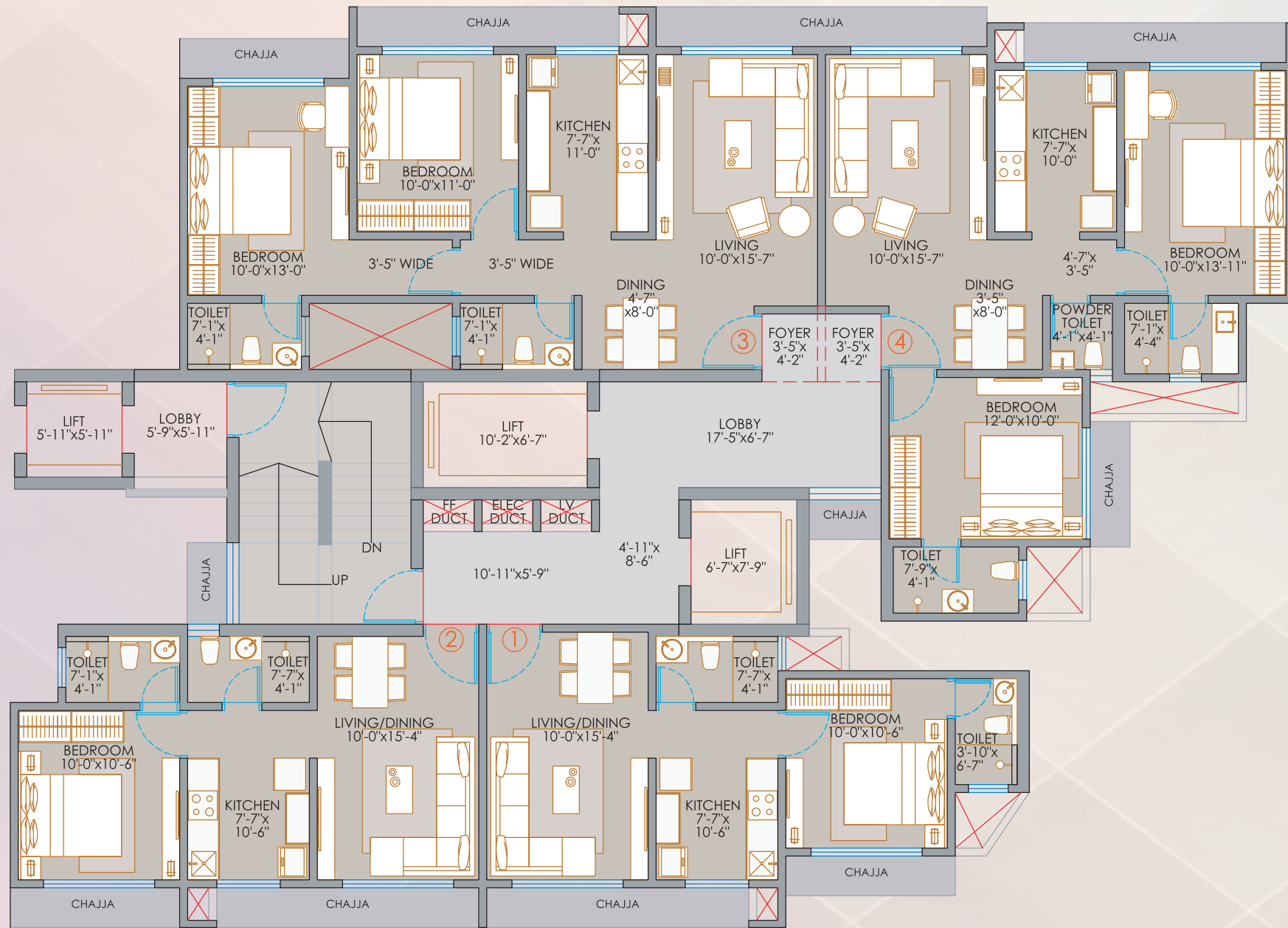

FLAT NO.	RERA CARPET AREA
1	415 Sq.Ft.
2	424 Sq.Ft.
3	699 Sq.Ft.
4	691 Sq.Ft.

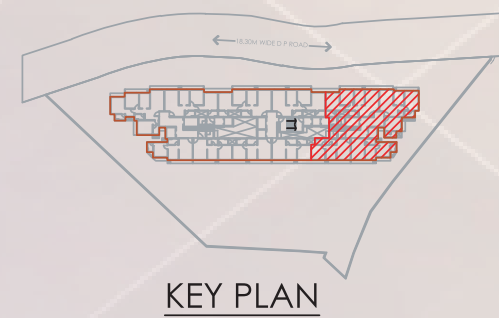

## Typical Floor Plan: Wing B

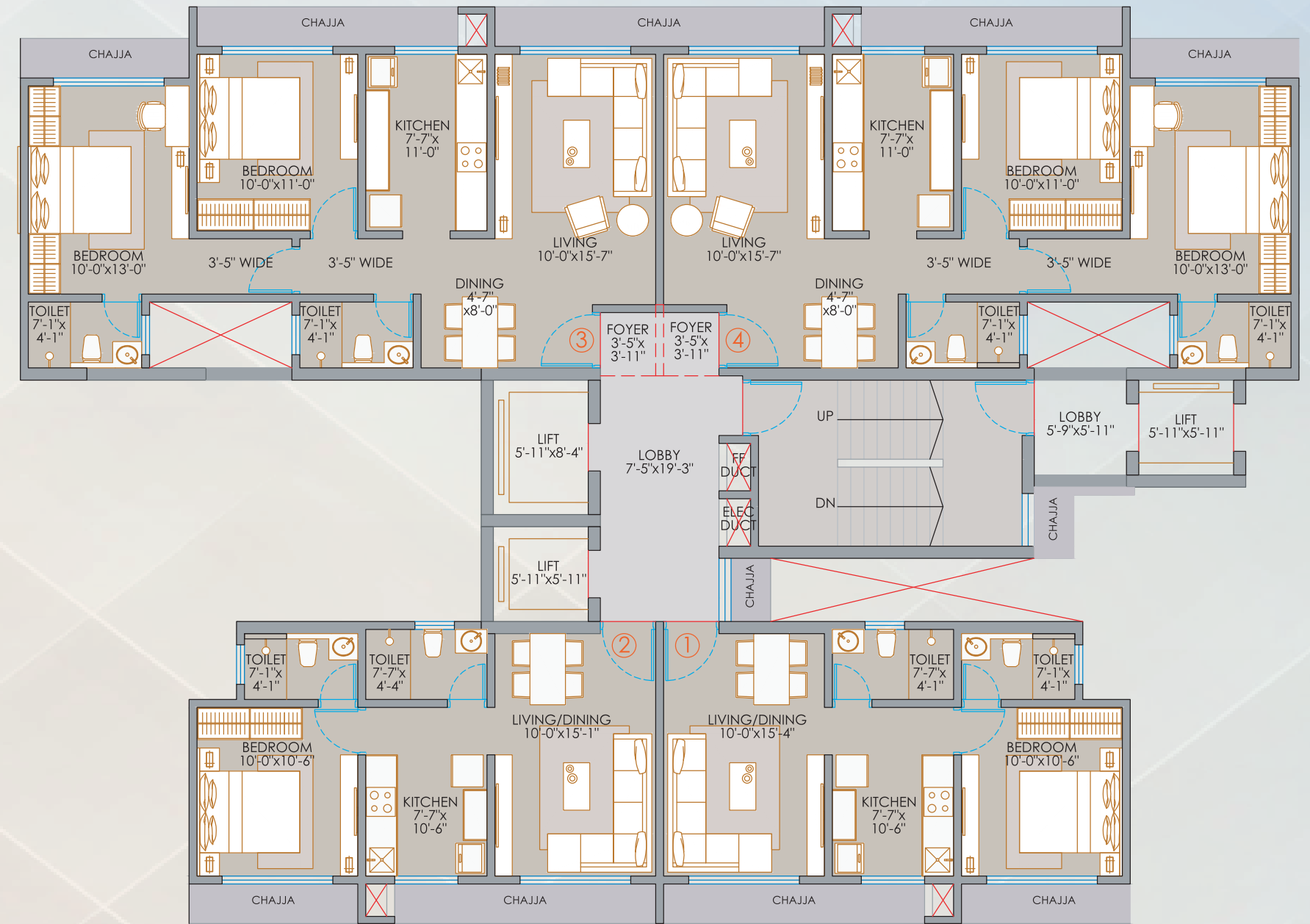

FLAT NO.	RERA CARPET AREA
1	424 Sq.Ft.
2	424 Sq.Ft.
3	698 Sq.Ft.
4	698 Sq.Ft.

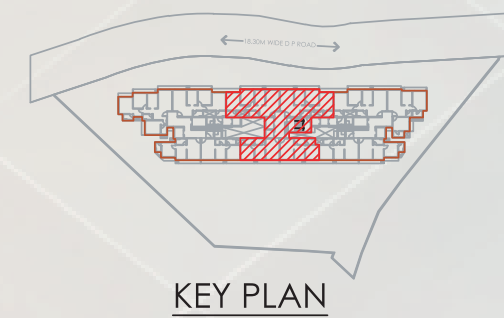

## Typical Floor Plan: Wing C



FLAT NO.	RERA CARPET AREA
1	424 Sq.Ft.
2	415 Sq.Ft.
3	879 Sq.Ft.
4	699 Sq.Ft.

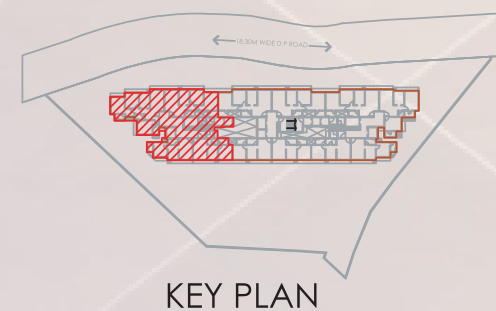

## LIST OF SPECIFICATIONS

- ENTRANCE FOYER**
  - Grand lobby with Italian marble/ Designer tiles
  - Fully Air-conditioned lobby
  - Reception/help desk with security
- ELEVATORS / TYPICAL FLOOR LOBBY**
  - Ventilated floor lobby
  - Dedicated high-quality elevator with service lifts
  - Designer elevator cabin interior
- LIVING ROOM AND BEDROOM**
  - Spacious Room Size
  - Adequate spaces for Family Time
  - Rooms are designed as per proper furniture planning and circulation.
- KITCHEN**
  - Well Ventilated Kitchen
  - Sufficient Spaces allocated for all Kitchen Appliances.
- TOILETS**
  - Hot & cold water diverter with shower in common toilets
  - Hot & cold water diverter with shower in master toilet
  - Premium Sanitary Fixtures.
- DOORS**
  - Wooden door frames
  - Hot-pressed solid core flush doors with a laminate finish
  - Designer hardware fittings
- WINDOWS**
  - Coloured powder coated /anodized aluminium sliding
  - windows with glass
  - Granite/marble window sills
- COMPOUND WALL & ENTRANCE GATE**
  - Designed compound wall as per architectural design
  - Attractive entrance gate as well as a covered security cabin
- PARKING & INTERNAL ROADS**
  - Driver and security toilets Provision on the ground floor
  - Cement concrete or paved block/checker tiles
  - Electric Charging for EV Vehicles.
  - Surface & Mechanical Parking systems.

- SECURITY SYSTEM & FEATURES**
  - 24 x 7 security within the campus.
  - Intercom facilities.
  - CCTV cameras in parking area & at common facilities.
  - Video door phone system for each flat.
- FLOORING**
  - Vitrified flooring in the living, dining, bedroom, and kitchen
- WALLS & CEILING**
  - Internal walls with gypsum finish and Lustre/Royal paint
  - Ceiling with gypsum finish and plastic paint
  - External walls sand-faced plaster with a textured finish and acrylic paint
- ELECTRICAL FITTINGS**
  - Sufficient electric points with branded modular switches
  - Concealed fire-resistant copper wiring
  - Ac, TV, and telephone/internet points provision
  - Earth leakage circuit breaker
- TOWER FEATURE**
  - Earthquake-resistant RCC framed structure
  - Firefighting systems for common area as per norms

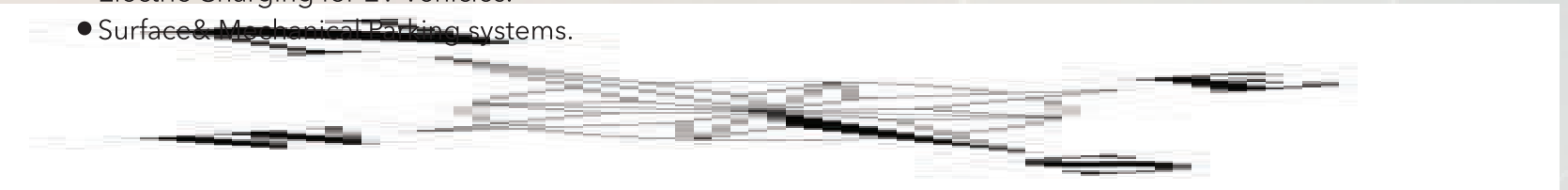





## ABOUT US

Veena Developers have been pioneering the league of providing housing and corporate spaces by offering world-class amenities to customers. Be it building highrise luxury housing spaces or building corporate spaces, we put our heart and soul into the development of the project and make sure that it surpasses the expectations of our customers. Our projects are at strategic locations and offer finest advantages of living in a connected world.

<b>32+</b>	<b>5300+</b>	<b>47.50+</b>	<b>08</b>	<b>3800+</b>	<b>30 +</b>
Projects Delivered	Happy Families	Lakhs sq.ft. Delivered	Ongoing Projctcs	To Be Happy Customers	Lakhs sq.ft. Under Construction

## ONGOING PROJECTS

**VEENA SMART HOMES**  
Kandivali (W)  
2 BHK Apartments



MahaRERA No: P51800029400 | P51800032966 | P51800031045  
TOTAL AREA: 6,85,000 Sq.Ft.

**VEENA SUYOG**  
Malad- West  
2 & 3 BHK Apartments

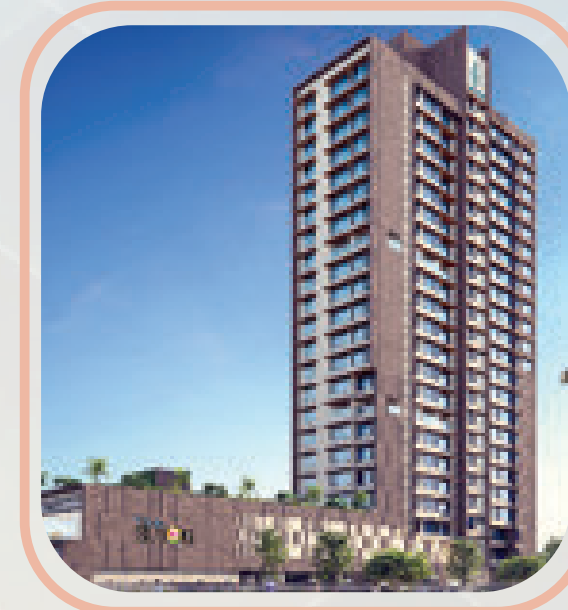

MahaRERA No. P51800050707  
TOTAL AREA: 1,11,000 Sq.Ft.

**9, BUSINESS BAY**  
Malad (W)  
Boutique offices



MahaRERA No: P51800032829  
TOTAL AREA: 3,50,000 Sq.Ft.

**VEENA SOLACE**  
Santacruz (W)  
2 & 3 BHK Apartments



MahaRERA No: P51800030138  
TOTAL AREA: 1,10,000 Sq.Ft.

**VEENA SERENE**  
Chembur  
2 BHK Apartments



MahaRERA No: P51800027781  
TOTAL AREA: 1,05,000 Sq.Ft.

**VEENA SAMRAJYA**  
Palghar  
1 RK & 1 BHK Apartments



MahaRERA No: P99000021726  
TOTAL AREA: 7,66,000 Sq.Ft.



A Project By:



Site Address: **Veena Synergy**, Sher-E-Punjab, Andheri East, Mumbai, Maharashtra 400093.

 **9071 999 063**

Website : [www.veenasynergy.com](http://www.veenasynergy.com) | Email : [sales@veenadevelopers.com](mailto:sales@veenadevelopers.com)

**Head office address:** A-901,9th floor, Kaledonia, Sahar Road, Opp. Sambhaji Nagar, Near Railway Station, Andheri [E], Mumbai - 400069.

Disclaimer: Veena Synergy this project Registered under  MahaRERA No.: P51800049356 & also available at website <https://maharera.mahaonline.gov.in>. This printed material does not constitute an offer or contract of any nature whatsoever between the Promoter/Developer and the recipient. All rendered visuals, images, and maps are the artist's conception and are for illustration purposes only unless otherwise mentioned. The developer does not warrant or assume any legal liability for the accuracy, completeness, or usefulness of any information disclosed here. All colors, furniture, and fixtures shown are for aesthetic representation purposes only and are not part of the flat offered for sale.

Scan for  MahaRERA

