

Gaurav  
**EXCELLENCY**

*An excellent lifestyle*  
Awaits you.



Modern Lifestyle  
comes with  
Modern Problems &  
**Modern Solutions.**

The greatest challenge in today's real estate market is striking the ideal balance between need and serenity. Ravi Group has ingrained this profoundly since their inception to not only provide our customers with the perfect property, but also a complete lifestyle that elevates their lives to a new level of heightened living. It has been our goal to build a life spacious enough to enable you to achieve all of your goals and soar to new heights.



A **3-STORIED** High-end **CLUB HOUSE**  
with top-of-the-line amenities.



## PODIUM Amenities

- 1 **Entry** to the residential tower
- 2 **Pool area:** Kids pool, Pool deck
- 3 **Pocket parks :** Seating, Amphitheatre, Senior citizen, Toddlers play area etc
- 4 **Plaza :** Seating, lounges installation etc.
- 5 **Kids play area :** Play equipments, sandpit, Crèches , Play Court area etc
- 6 **Society Office**
- 7 **Open GYM**
- 8 **Health Care Centre**
- 9 **Club house**
- 10 **Garden**





THE ROYAL LIVING  
does not deserve anything  
less than SUPREME





You will find this home has many comfort features for your lifestyle that are not available elsewhere!

## AMENITIES

1. Swimming Pool
2. Well-Equipped Club House
3. Kids Play Area
4. Kids Swimming Pool
5. Gymnasium
6. Jogging Track
7. Sauna Spa Room
8. Open Gym
9. Green Walkway
10. Indoor Games
11. Lounges & Seating Area
12. Podium Parking
13. Meditation room
14. Cafeteria with Wi-fi lounge
15. Well-decorated double height entrance lobby
16. Single level + podium parking
17. 24x7 Security
18. Two lifts per wing

With hassle-free travels,  
experience the pinnacle of  
**EASY ACCESSIBILITY**

Gaurav Excellency offers residents the opportunity to live in a posh neighbourhood close to all civic and recreational facilities. Get anywhere in Mumbai in a matter of minutes by taking the Western Express Highway.





## LOCATION ADVANTAGES:

### ENTERTAINMENT :

- |                          |                                     |
|--------------------------|-------------------------------------|
| GCC Club - 500 m         | Thakur Mall - 3.5 Km                |
| Cinemax Theatre - 1.2 Km | Maxus Mall - 5 Km                   |
| Western Hotel - 1.4 Km   | Gorai beach - 15 Km                 |
| Dhara's Dhaba - 1.5 Km   | Essel World & Water Kingdom - 16 Km |
| Rassaz Theatre - 2.3 Km  | Global Paghoda - 19 Km              |
| Seven Eleven Club - 3 Km |                                     |

### CONNECTIVITY :

- Western Express Highway - 1.5 Km
- Proposed Metro Station - 1.5 Km
- Chodbunder Road - 2.2 km
- Miraroad Railway Station - 3.5 Km
- International Airport - 23 Km

### HOSPITALS :

- Wockhardt Hospital - 3.1 Km
- Tunga Hospital - 3.3 Km
- Bhakti Vedanta Hospital - 3.5 Km
- Indira Gandhi Hospital - 4.1 Km

### RETAIL :

- D- Mart - 1.3 Km
- Brand Factory - 1.4 Km
- Rassaz Mall - 2.3 Km
- Star Market - 2.4 Km
- Market Point - 2.8 Km

### SCHOOLS & COLLAGES :

- Sardar Vallabhbhai Patel Vidyalaya - 2.5 Km
- St Xavier's High School - 2.7 Km
- Seven Eleven Scholastic School - 2.8 Km
- N. L. Dalmia School & Collge - 2.9 Km
- Royal College - 2.9 Km
- Abhinav School & College - 3.6 Km



# MASTER LAYOUT PLAN

- 1. Antaiya Podium 90,000 Sq.ft.
- 2. Green Area 25,000 Sq.ft.
- 3. Club House 28,000 Sq.ft.
- 4. Cricket Court 2500 Sq.ft.
- 5. Play Court 7300 Sq.ft.
- 6. Kids Play Area 6000 Sq.ft.
- 7. Social Activities 13000 Sq.ft.
- 8. Jogging Track / 1.0 Kilo Meter Green Walkaway



# TYPICAL FLOOR PLAN

## Building no. 09

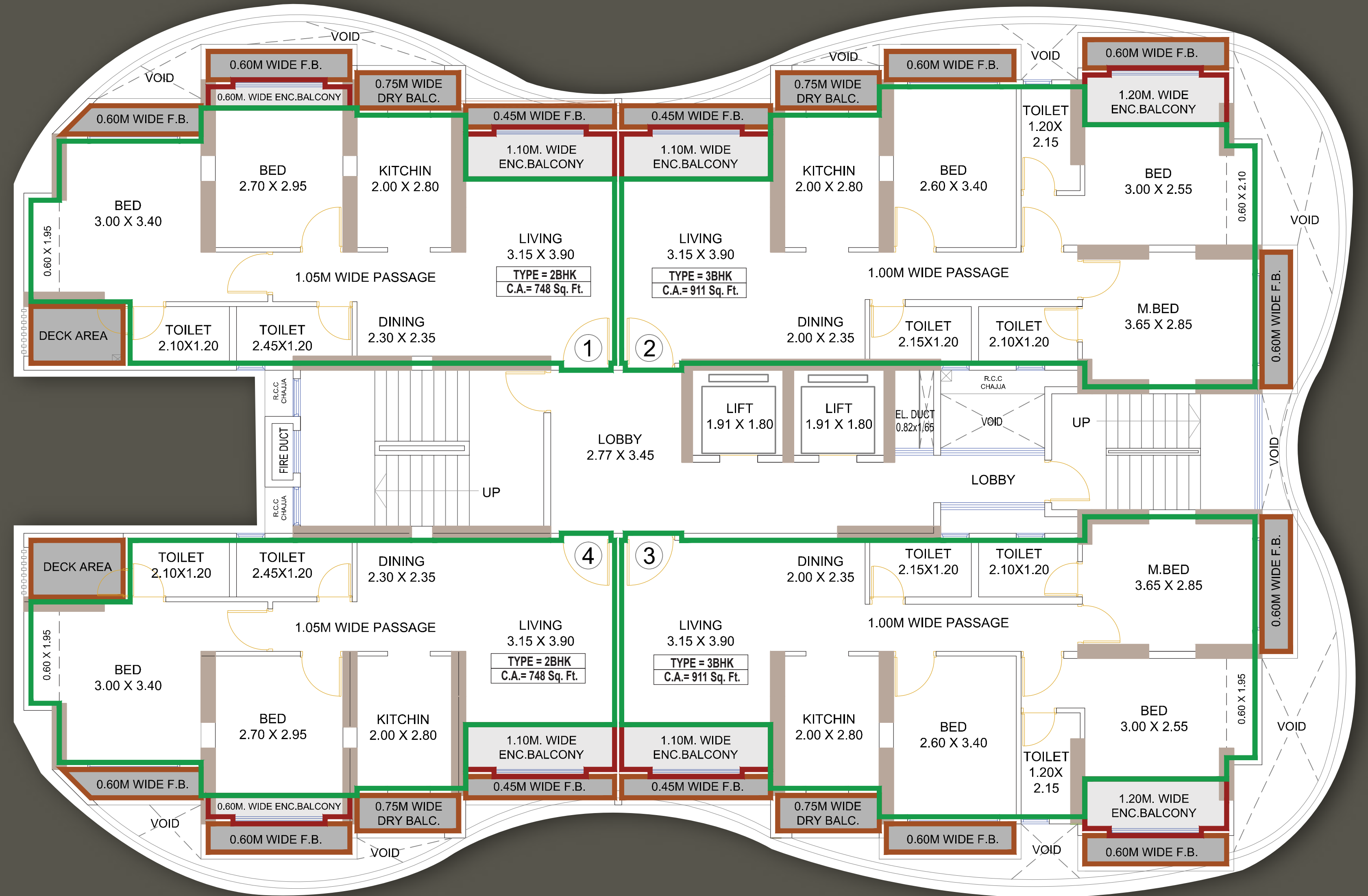

SCAN TO KNOW MORE



**RAVI GROUP**

Reg. Office: 76, Laxmi Palace, Mathuradas Road, Kandivali (West), Mumbai - 400067

Site Office: Gaurav Excellency, Near GCC Club, Hatkesh Udhyog Nagar, Mira Road (E) Thane - 401107.

Contact: +91 84548 46400 / 84548 46311 | E-mail: enquiry@ravigroup.in | Website: www.ravigroup.in



Registration No:  
**P51700006232**

Follow us on:   

Disclaimer: The Information contained in this advertisement is indicative of the kind of development that is proposed and it is subjective to the authorities or otherwise the developers reserve their right to make change or alteration at their sole discretion. all pictures used are rendered according to the artist's perception.\*Conditions apply.